

South Australia

## **Highways (Control of Access—Riddoch Highway) Proclamation 2003**

under section 30A(1)(a) of the *Highways Act 1926*

### **1—Short title**

This proclamation may be cited as the *Highways (Control of Access—Riddoch Highway) Proclamation 2003*.

### **2—Commencement**

This proclamation comes into operation on the day on which it is made.

### **3—Controlled-access roads**

- (1) The land shaded in grey on the plan in Schedule 1 is a controlled-access road.
- (2) The land shaded in grey on the plan in Schedule 2 is a controlled-access road.

### **4—Routes and means of access**

The routes and means of access by which persons and vehicles may enter or leave the controlled-access roads declared in clause 3 are as shown on the respective plans referred to in that clause.

Schedule 1—Plan

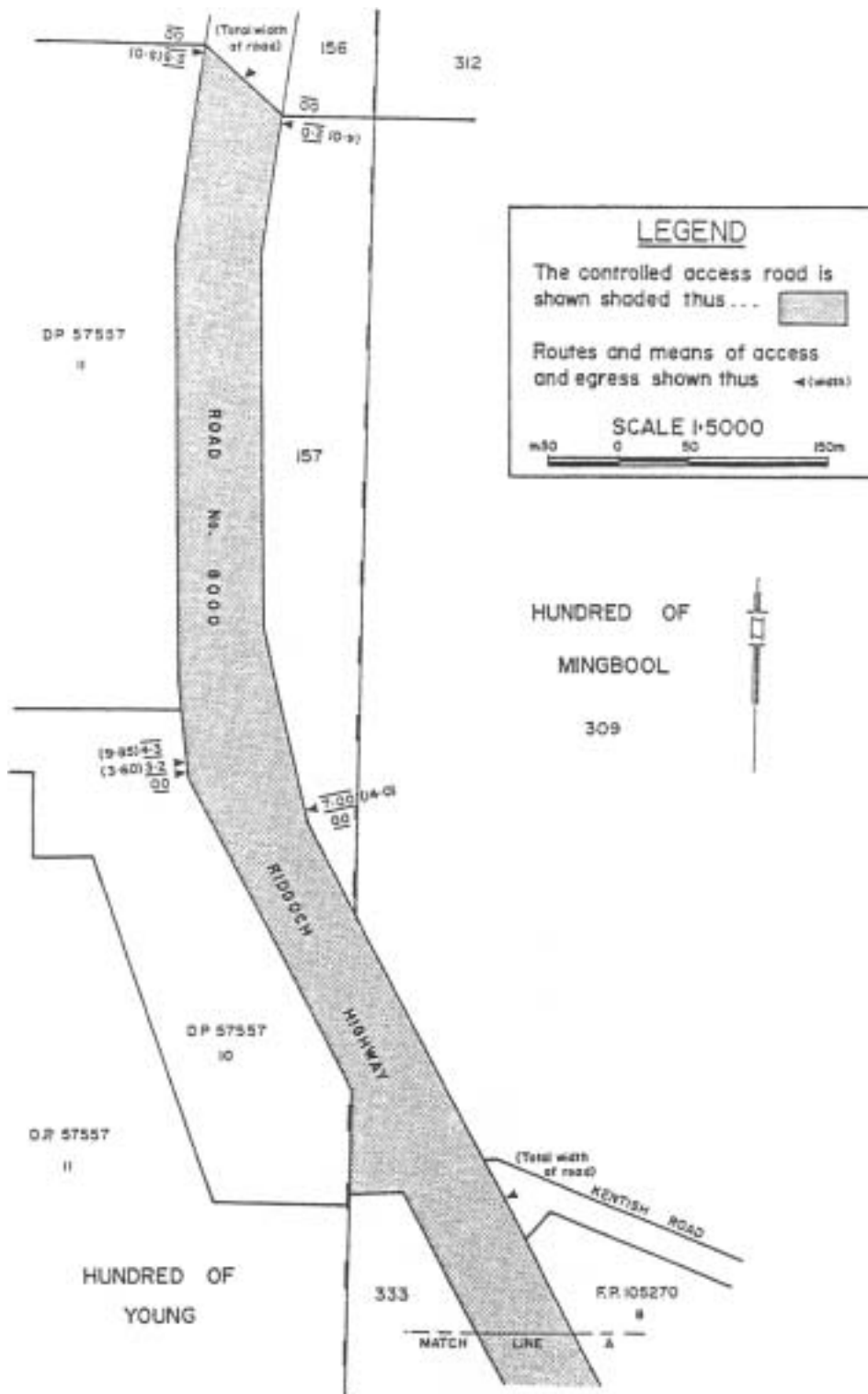

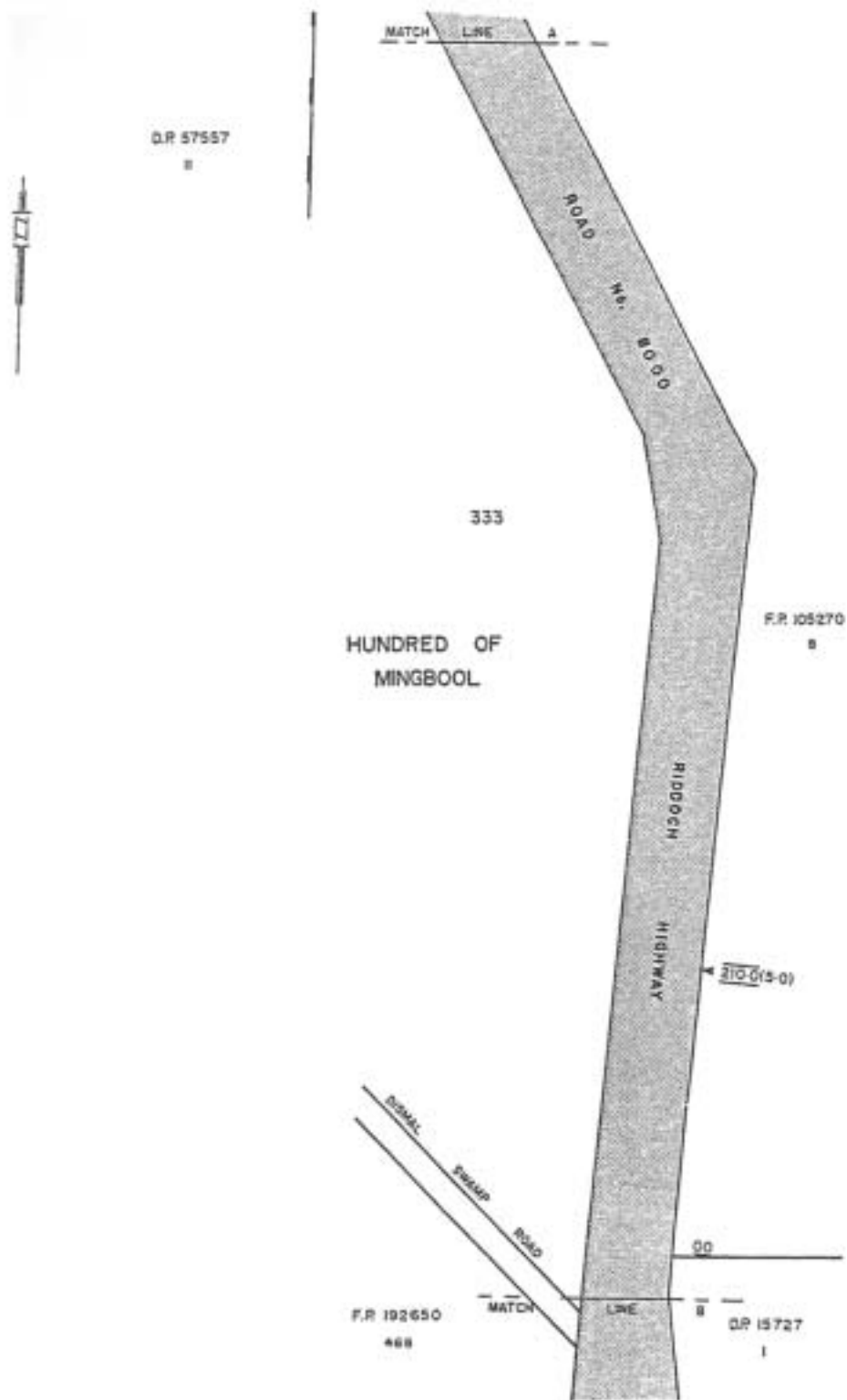

Highways (Control of Access—Riddoch Highway) Proclamation 2003

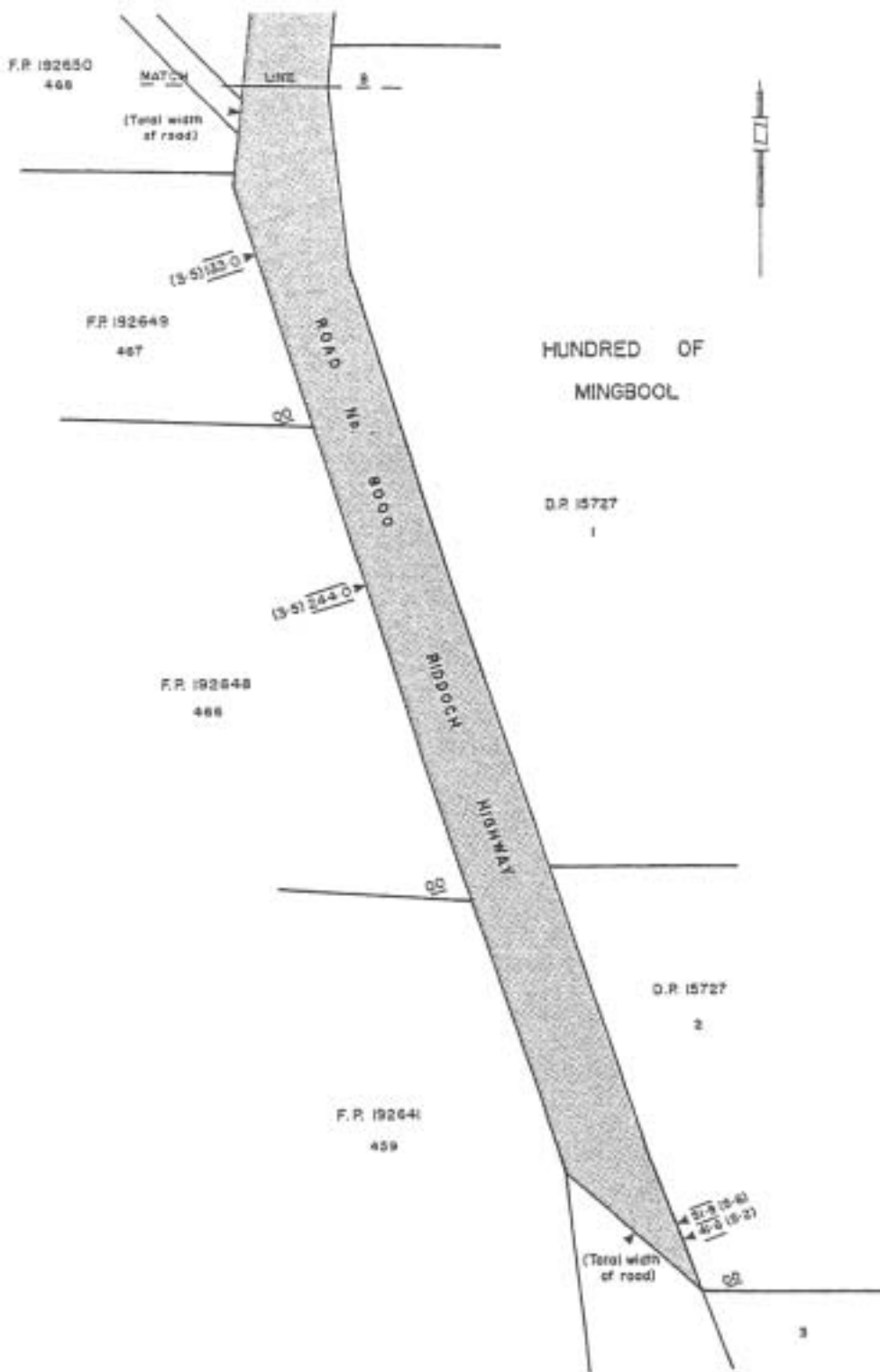

Schedule 2—Plan

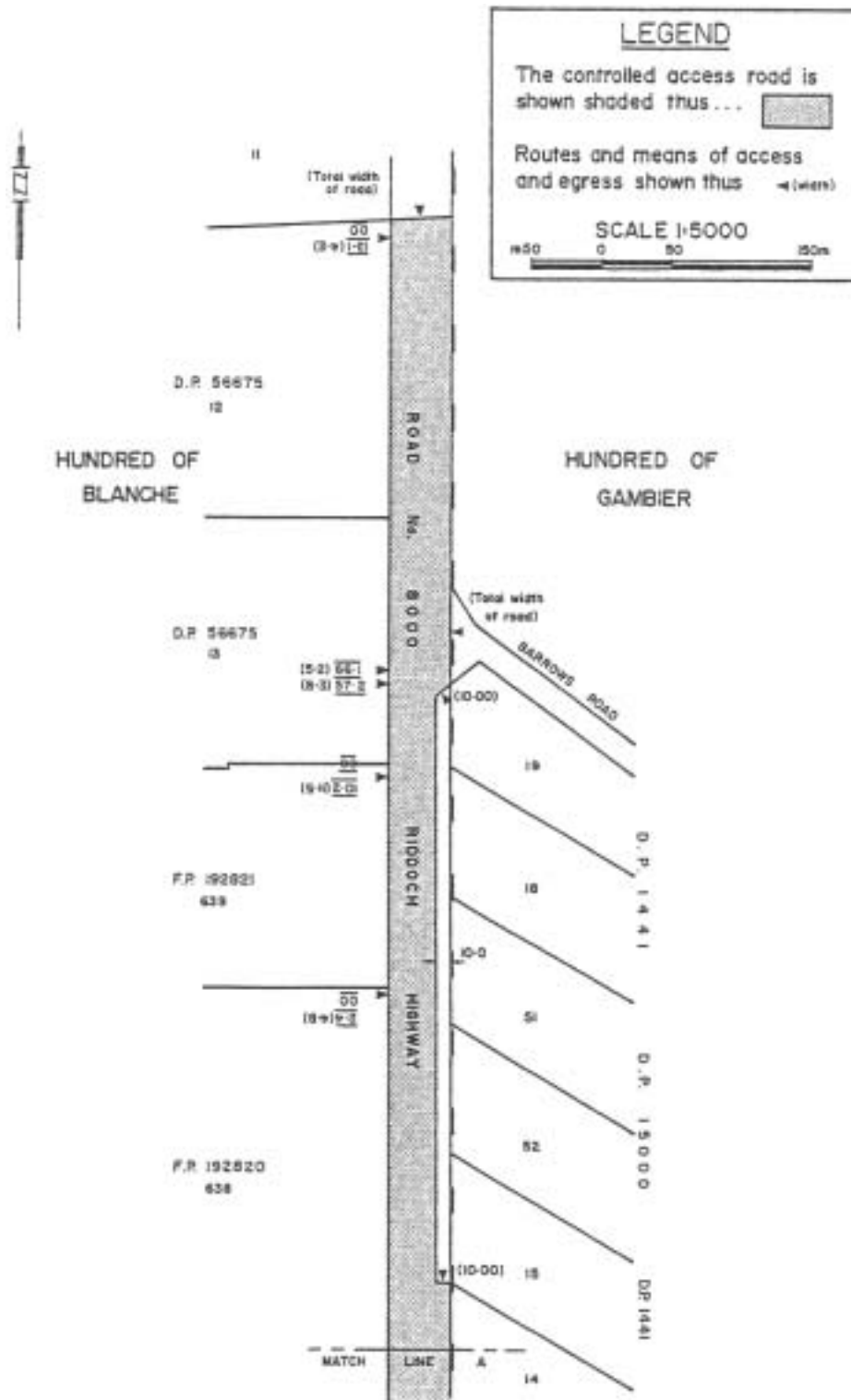

**Highways (Control of Access—Riddoch Highway) Proclamation 2003**

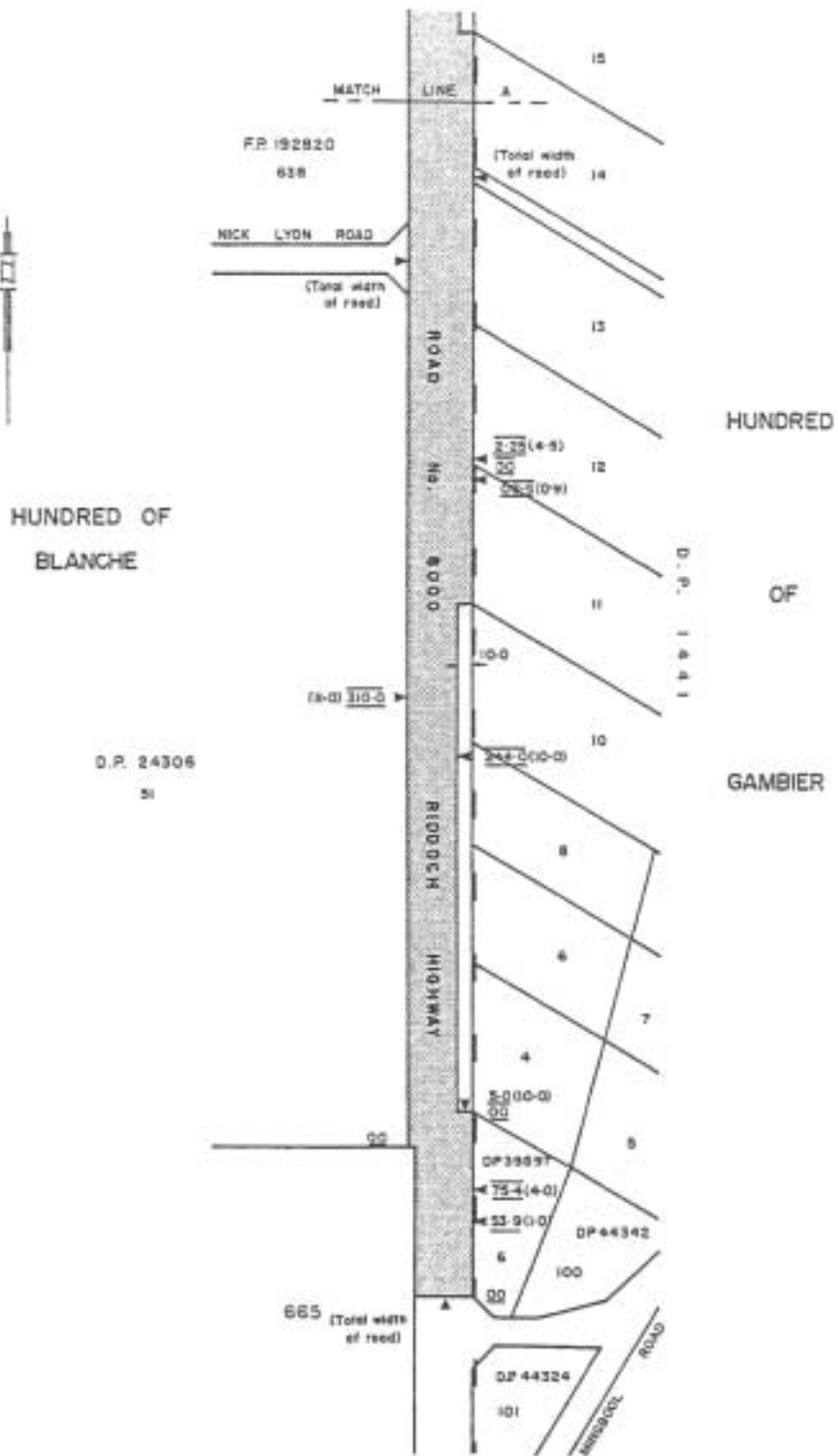

**Made by the Governor**

on the recommendation of the Commissioner of Highways and with the advice and consent of the Executive Council  
on 29 May 2003

CTSA2002/13026