

South Australia

Liquor Licensing (Dry Areas—Long Term) Variation Regulations 2003

under the *Liquor Licensing Act 1997*

Contents

Part 1—Preliminary

- 1 Short title
- 2 Commencement
- 3 Variation provisions

Part 2—Variation of *Liquor Licensing (Dry Areas—Long Term) Regulations 1997* (Gazette 6.11.1997 p 1217) as varied

- 4 Variation of Schedule 1—Long term dry areas
- 5 Variation of Schedule 2—Plans of long term dry areas

Schedule—Plan of long term dry area

Part 1—Preliminary

1—Short title

These regulations may be cited as the *Liquor Licensing (Dry Areas—Long Term) Variation Regulations 2003*.

2—Commencement

These regulations come into operation on the day on which they are made.

3—Variation provisions

In these regulations, a provision under a heading referring to the variation of specified regulations varies the regulations so specified.

Part 2—Variation of *Liquor Licensing (Dry Areas—Long Term) Regulations 1997* (Gazette 6.11.1997 p 1217) as varied

4—Variation of Schedule 1—Long term dry areas

Schedule 1—after item headed "**Glenelg—Area 1**" insert:

Goolwa—Area 1

(see Schedule 2: Goolwa—Plan No 1)

<i>Area</i>	<i>Period</i>	<i>Extent of prohibition</i>
The area adjacent to Goolwa, encompassing the Goolwa Skate Park and an abutting carpark, bounded as follows: commencing at the point at which the southerly prolongation in a straight line of the line of the western wall of the Goolwa Sports Stadium intersects the northern boundary of Glendale Grove, then westerly along that boundary of Glendale Grove for a distance of 140 metres, then northerly in a straight line at right angles to that boundary of Glendale Grove for a distance of 65 metres, then easterly in a straight line parallel to the northern boundary of Glendale Grove to the northerly prolongation in a straight line of the line of the western wall of the Goolwa Sports Stadium, then southerly along that prolongation, wall and the southerly prolongation in a straight line of the wall line to the point of commencement.	Continuous until 24 April 2004.	The consumption and possession of liquor are prohibited.

5—Variation of Schedule 2—Plans of long term dry areas

Schedule 2—after plan headed "**Glenelg—Plan No. 1**" insert the plan in the Schedule of these regulations.

Schedule—Plan of long term dry area

Goolwa-Plan No 1

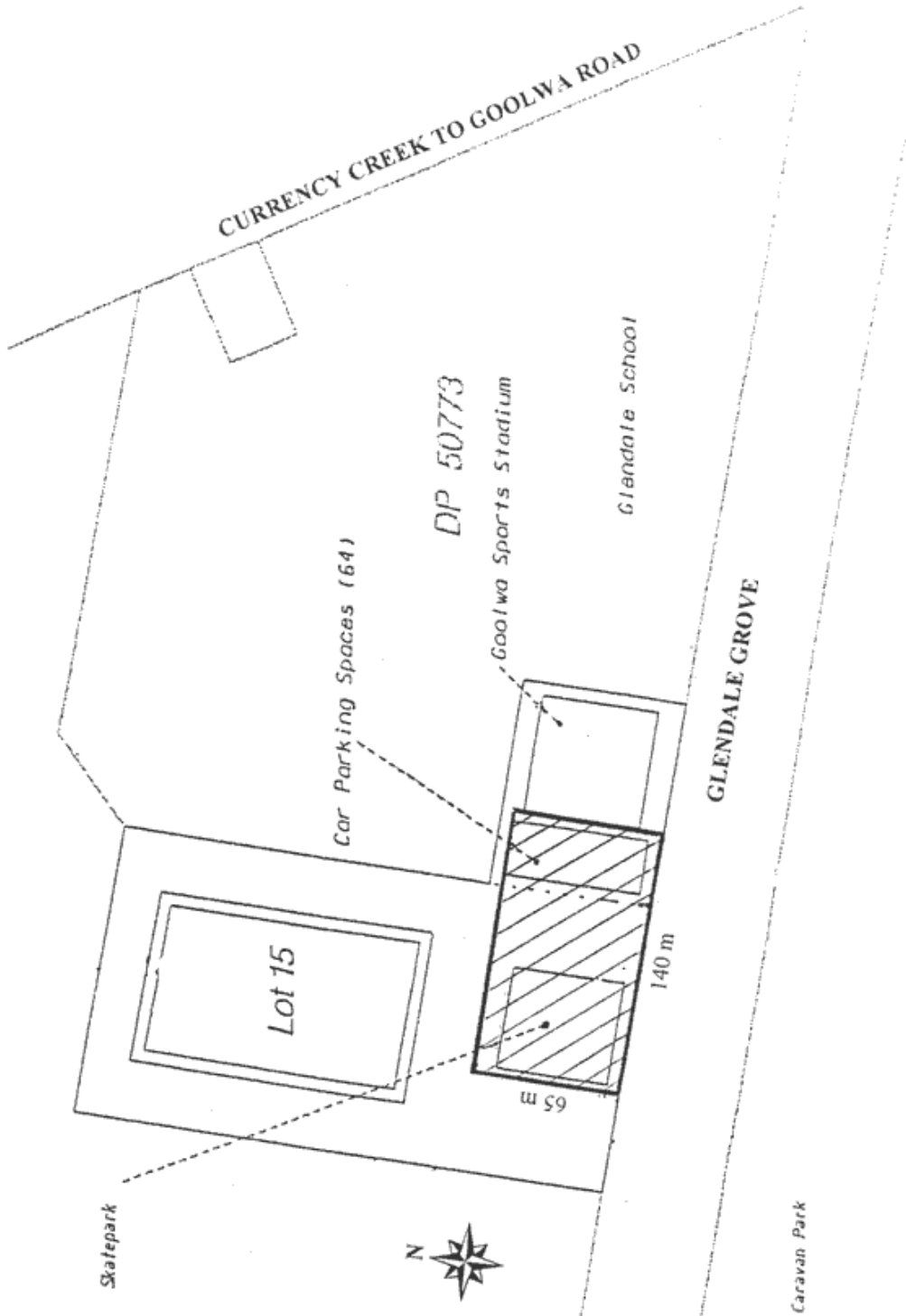

Note—

As required by section 10AA(2) of the *Subordinate Legislation Act 1978*, the Minister has certified that, in the Minister's opinion, it is necessary or appropriate that these regulations come into operation as set out in these regulations.

Made by the Governor

with the advice and consent of the Executive Council
on 22 May 2003

No 49 of 2003

OLGC 4/2003