

South Australia

Highways (Port River Expressway Project) Variation Regulations 2009

under the *Highways Act 1926*

Contents

Part 1—Preliminary

- 1 Short title
- 2 Commencement
- 3 Variation provisions

Part 2—Variation of *Highways (Port River Expressway Project) Regulations 2004*

- 4 Variation of regulation 4—Port River Expressway Project
 - 5 Variation of Schedule 1—Principal features of Port River Expressway Project
 - 6 Substitution of Schedule 2
- Schedule 2—Land to which Port River Expressway Project applies
-

Part 1—Preliminary

1—Short title

These regulations may be cited as the *Highways (Port River Expressway Project) Variation Regulations 2009*.

2—Commencement

These regulations come into operation on the day on which they are made.

3—Variation provisions

In these regulations, a provision under a heading referring to the variation of specified regulations varies the regulations so specified.

Part 2—Variation of *Highways (Port River Expressway Project) Regulations 2004*

4—Variation of regulation 4—Port River Expressway Project

Regulation 4(2)—delete "the bold black line shown in the plans (Figures 2 to 5) set out" and substitute:

the bold black line connecting the coordinate points shown in Figures 2 to 5

5—Variation of Schedule 1—Principal features of Port River Expressway Project

Schedule 1, Part 4, Figure 1—delete Figure 1 and substitute:

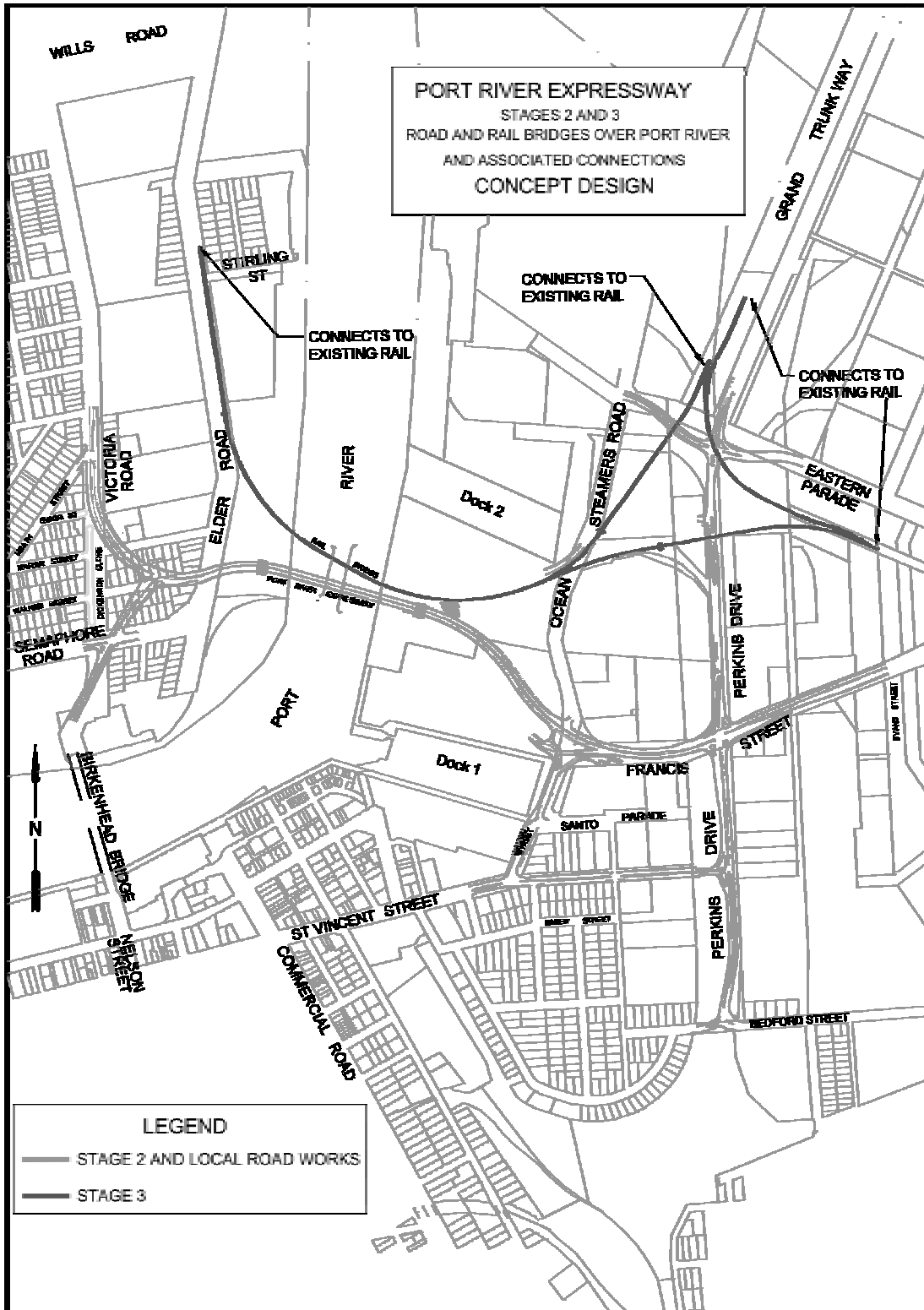

Figure 1

6—Substitution of Schedule 2

Schedule 2—delete the Schedule and substitute:

**Schedule 2—Land to which Port River Expressway
Project applies**

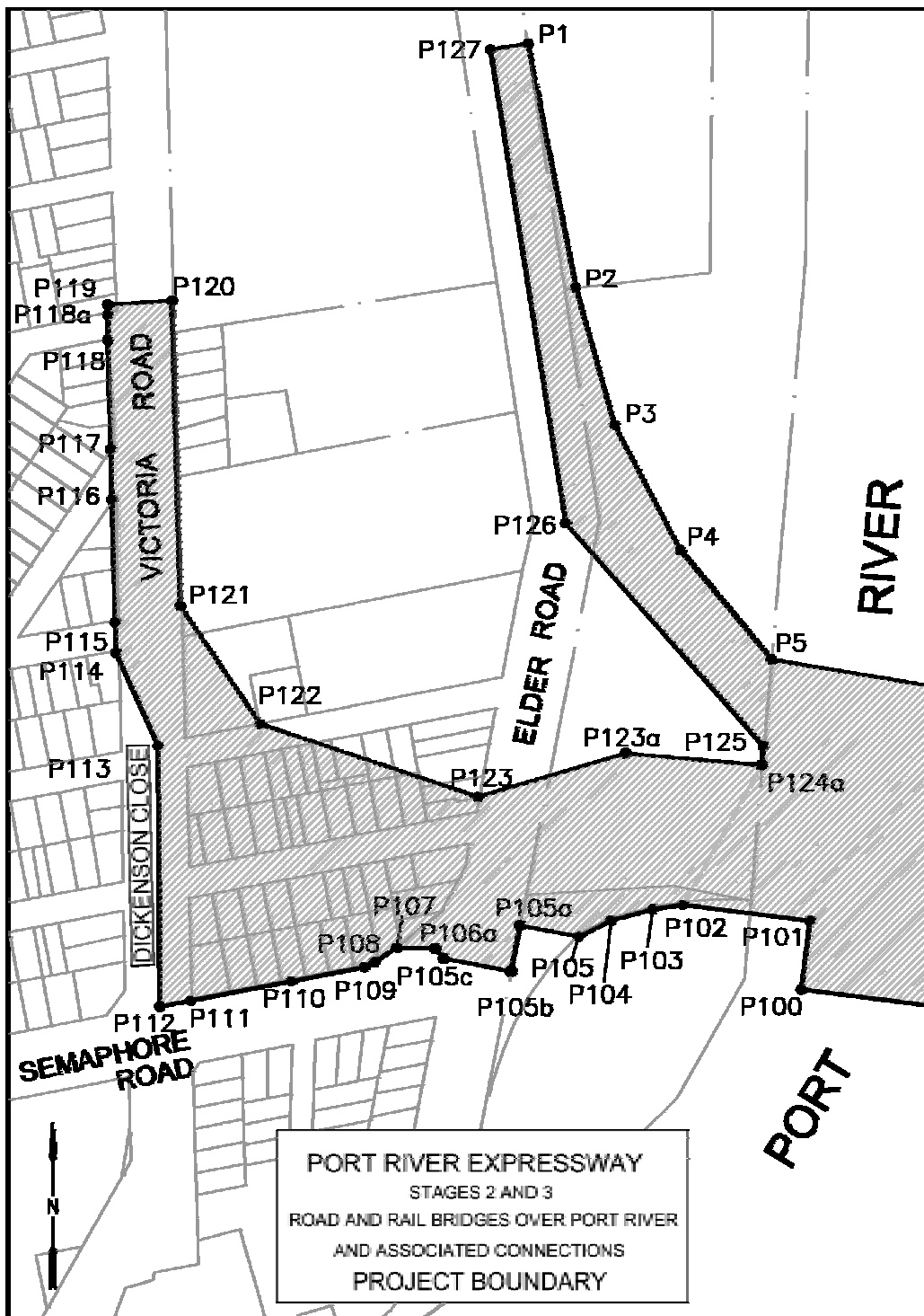

Figure 2

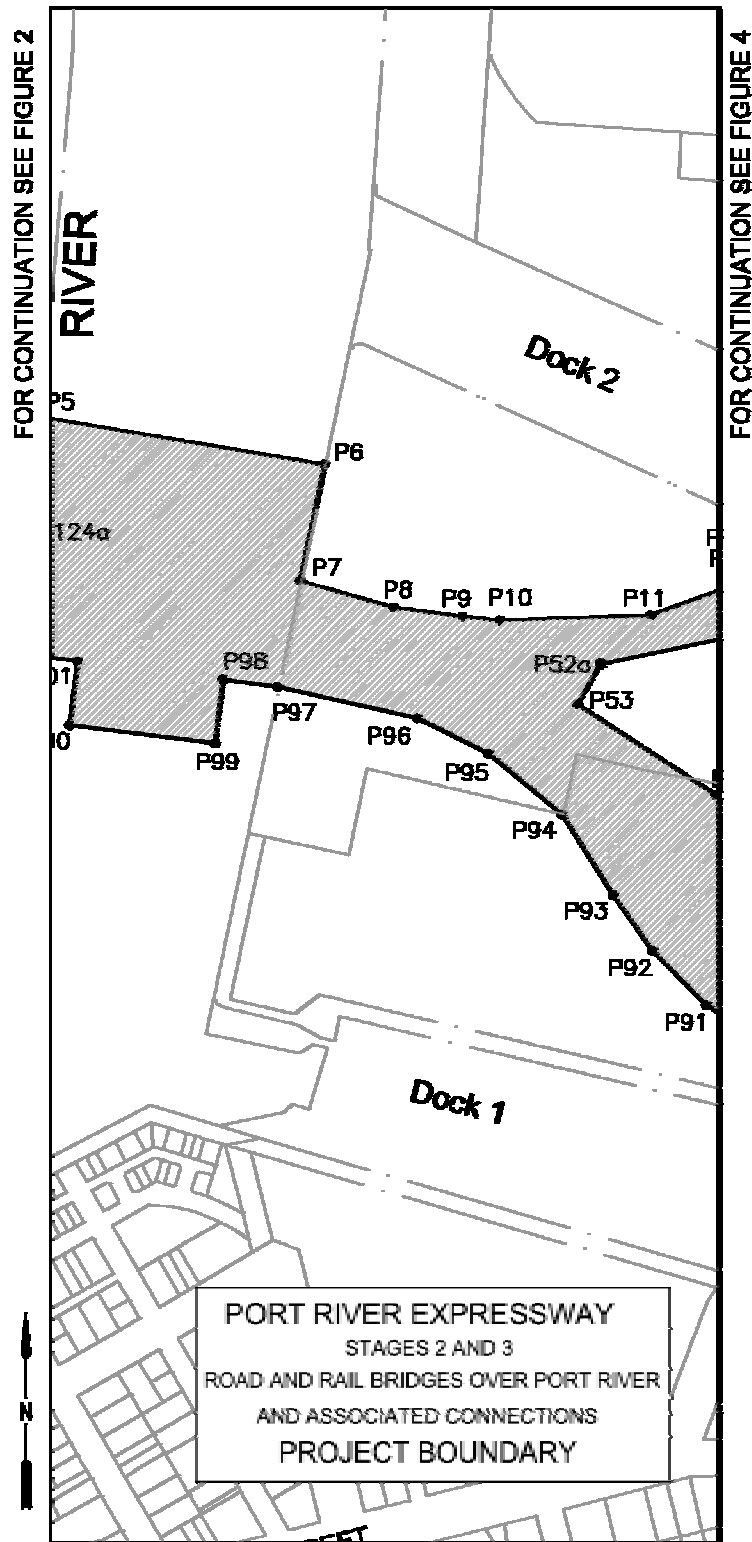
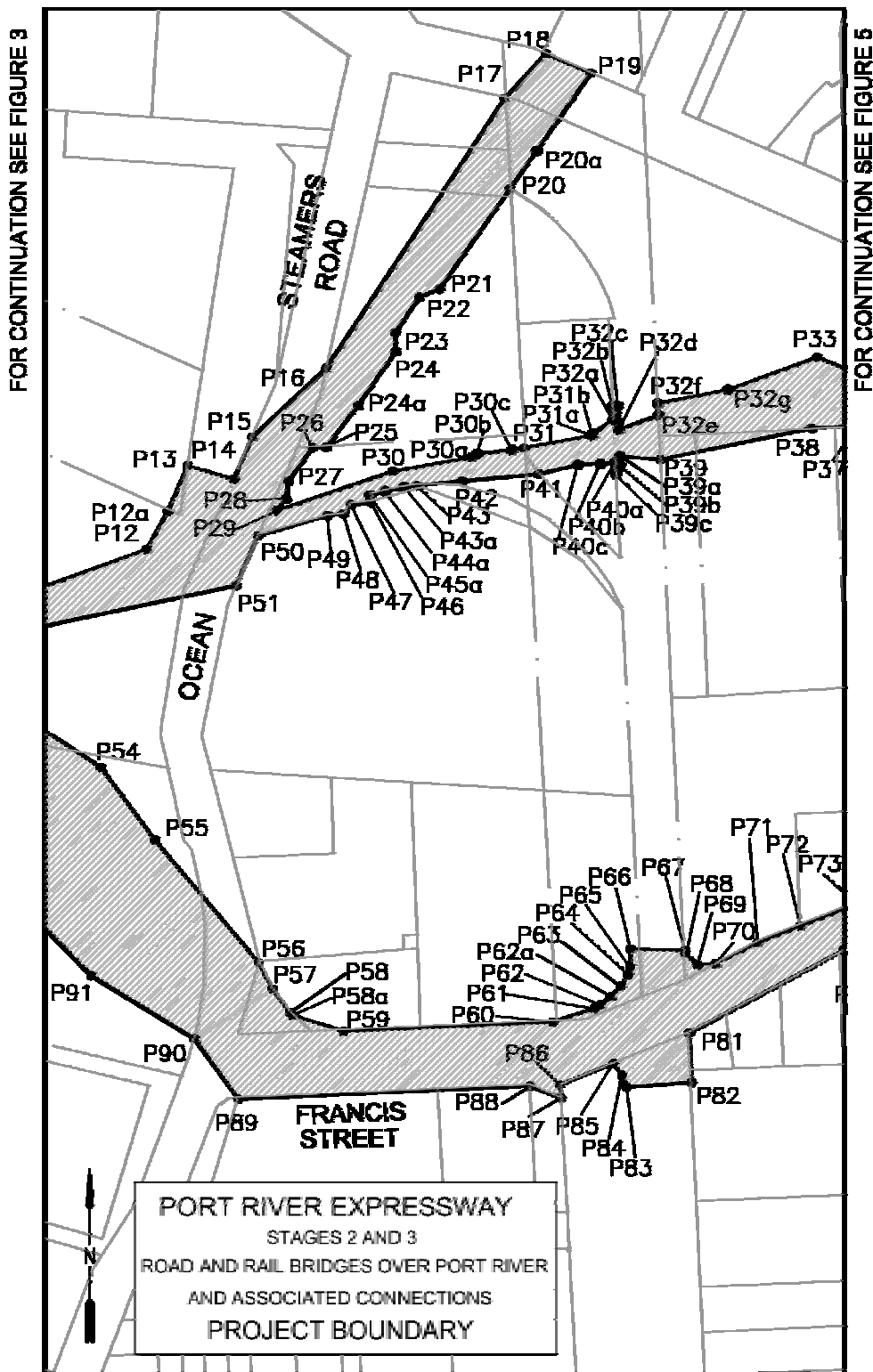

Figure 3



Figures 4

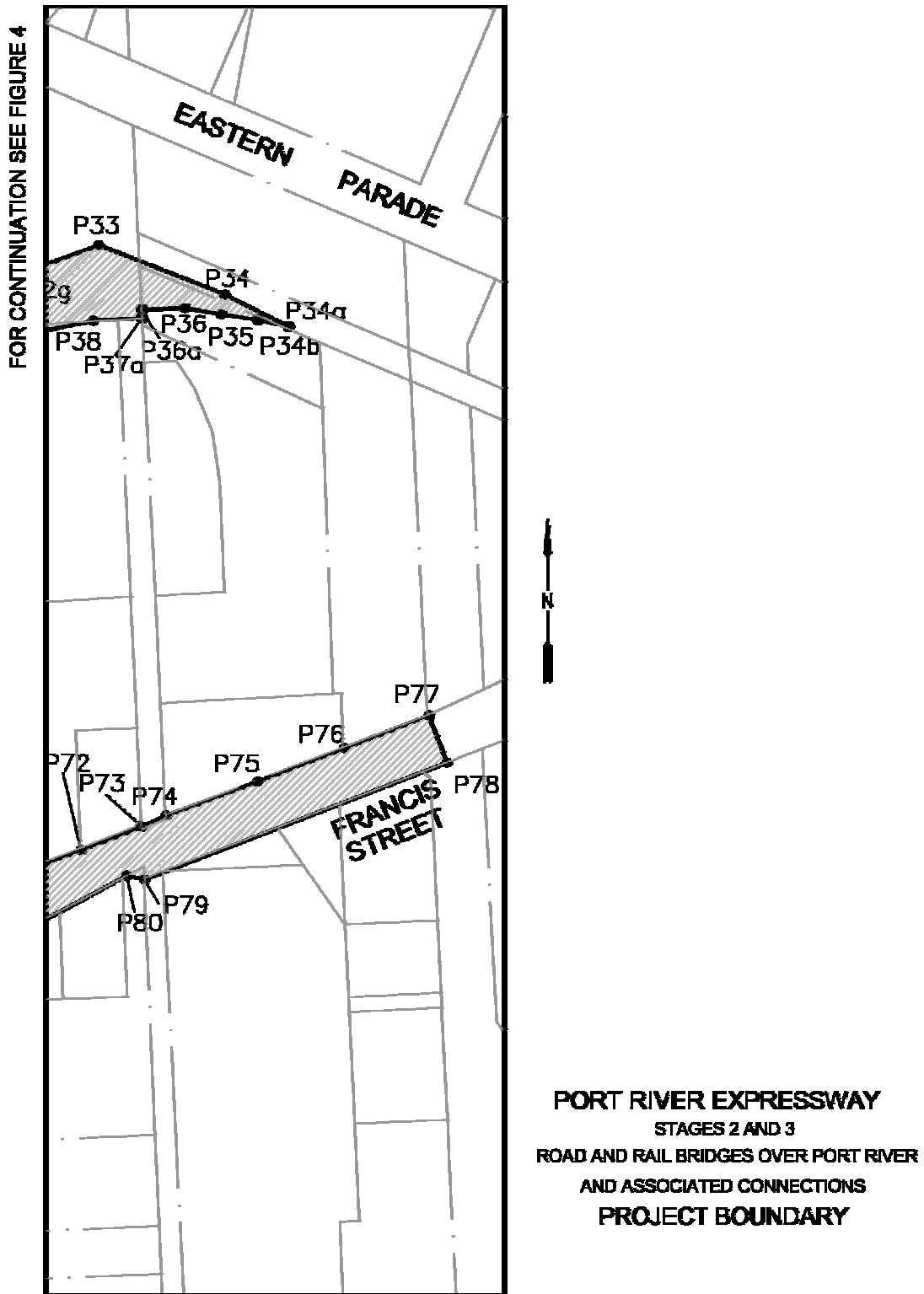

Figure 5

Explanation of Coordinates shown in Figures 2 to 5—

- 1 The Coordinate Origin is Permanent Survey Mark S317 (E=50000 N=100000, local in metres) that is located on the southern corner of Victoria Road and Heath Street, Cadastral No 6628/18085.
- 2 The Point Nos and Coordinates shown in Figures 2 to 5 are defined in the table below.

Point No	Coordinates	
1	E=50255.093742	N=100280.466961
2	E=50284.469641	N=100130.194413
3	E=50308.355774	N=100046.041002
4	E=50349.065143	N=99968.665976
5	E=50405.081495	N=99901.536880
6	E=50591.558382	N=99870.563362
7	E=50575.031897	N=99793.754809
8	E=50636.806950	N=99776.249925
9	E=50682.112751	N=99770.354818
10	E=50706.695341	N=99767.847600
11	E=50805.950983	N=99770.947036
12	E=50879.305329	N=99797.742481
12a	E=50893.476599	N=99823.324470
13	E=50906.761873	N=99853.588072
14	E=50937.245930	N=99844.646885
15	E=50949.674738	N=99872.425437
16	E=50999.032592	N=99918.567716
17	E=51117.341000	N=100098.102000
18	E=51144.684453	N=100127.767420
19	E=51174.756242	N=100114.961019
20	E=51120.715208	N=100037.653696
20a	E=51138.574510	N=100063.092203
21	E=51074.096859	N=99971.201679
22	E=51060.777584	N=99965.688945
23	E=51044.668530	N=99941.887035
24	E=51044.960323	N=99929.441355
24a	E=51019.918389	N=99893.460816
25	E=50998.634035	N=99865.924412
26	E=50989.622495	N=99865.421832
27	E=50973.645105	N=99843.014211

Highways (Port River Expressway Project) Variation Regulations 2009
Part 2—Variation of *Highways (Port River Expressway Project) Regulations 2004*

Point No	Coordinates	
28	E=50971.921662	N=99831.365568
29	E=50965.790717	N=99823.433724
30	E=51042.790068	N=99849.718465
30a	E=51095.525607	N=99859.116393
30b	E=51099.103000	N=99861.432000
30c	E=51122.121000	N=99863.856000
31	E=51130.373864	N=99865.326608
31a	E=51175.523619	N=99873.593837
31b	E=51175.406374	N=99874.678969
32a	E=51189.409371	N=99884.051193
32b	E=51188.960979	N=99893.120115
32c	E=51192.356831	N=99893.288015
32d	E=51193.121670	N=99877.429132
32e	E=51219.346967	N=99887.028116
32f	E=51219.058860	N=99894.918496
32g	E=51265.602917	N=99903.958719
33	E=51324.902946	N=99925.663716
34	E=51403.634946	N=99894.762502
34a	E=51443.495229	N=99874.652234
34b	E=51424.341836	N=99878.964592
35	E=51401.366088	N=99882.333263
36	E=51378.768997	N=99886.294186
36a	E=51351.681675	N=99885.286143
37a	E=51351.937792	N=99879.853471
38	E=51321.614368	N=99878.424100
39	E=51220.902188	N=99857.658860
39a	E=51193.970143	N=99859.836123
39b	E=51194.286113	N=99853.284510
39c	E=51191.206466	N=99847.788532
40a	E=51190.782724	N=99855.745861
40b	E=51180.900094	N=99854.780246
40c	E=51165.869146	N=99854.200626
41	E=51139.704534	N=99847.938893
42	E=51088.890361	N=99843.203021
43	E=51058.833914	N=99840.401765
43a	E=51050.588000	N=99839.264000

Highways (Port River Expressway Project) Variation Regulations 2009
Variation of *Highways (Port River Expressway Project) Regulations 2004*—Part 2

Point No	Coordinates	
44a	E=51037.747000	N=99836.538000
45a	E=51027.742000	N=99833.818000
46	E=51028.671306	N=99828.996545
47	E=51015.067034	N=99827.691523
48	E=51010.193934	N=99821.313397
49	E=50999.519720	N=99820.336380
50	E=50953.400793	N=99806.734121
51	E=50938.615572	N=99773.609429
52a	E=50773.337141	N=99738.789166
53	E=50757.998103	N=99712.226760
54	E=50849.142305	N=99652.374575
55	E=50884.919267	N=99604.164579
56	E=50954.120727	N=99522.472431
57	E=50963.028900	N=99505.147082
58	E=50974.694129	N=99489.500765
58a	E=50976.687312	N=99487.584362
59	E=51010.397158	N=99476.945829
60	E=51149.168951	N=99483.022273
61	E=51177.007041	N=99492.135074
62	E=51180.970307	N=99494.338663
62a	E=51187.781321	N=99500.046779
63	E=51194.315627	N=99506.736892
64	E=51199.396039	N=99514.588272
65	E=51200.721378	N=99519.896103
66	E=51201.065492	N=99531.719106
67	E=51237.078321	N=99530.670934
68	E=51237.176600	N=99528.693743
69	E=51245.562117	N=99521.098855
70	E=51257.291903	N=99521.679221
71	E=51285.481363	N=99536.020608
72	E=51313.845934	N=99546.952818
73	E=51351.844699	N=99561.601101
74	E=51366.774000	N=99568.574236
75	E=51424.153155	N=99589.901647
76	E=51478.239243	N=99610.814050
77	E=51531.119308	N=99631.260444

Highways (Port River Expressway Project) Variation Regulations 2009
Part 2—Variation of *Highways (Port River Expressway Project) Regulations 2004*

Point No	Coordinates	
78	E=51542.565292	N=99601.668100
79	E=51353.396721	N=99528.501438
80	E=51342.424502	N=99530.894489
81	E=51239.827430	N=99475.658410
82	E=51241.451221	N=99442.692053
83	E=51198.367998	N=99439.807980
84	E=51195.461736	N=99447.604692
85	E=51189.660398	N=99455.450445
86	E=51154.231000	N=99441.179000
87	E=51154.722716	N=99432.503573
88	E=51134.131307	N=99440.295735
89	E=50940.235423	N=99431.763619
90	E=50911.240890	N=99471.848756
91	E=50842.640167	N=99513.855106
92	E=50807.269772	N=99549.723035
93	E=50781.385794	N=99586.323419
94	E=50747.546625	N=99639.809839
95	E=50699.115982	N=99679.766673
96	E=50652.420970	N=99703.058309
97	E=50560.379470	N=99724.043421
98	E=50524.461385	N=99728.605017
99	E=50518.981926	N=99686.550157
100	E=50423.232321	N=99698.569624
101	E=50428.729818	N=99740.762927
102	E=50350.482672	N=99750.700314
103	E=50331.953638	N=99747.979616
104	E=50306.313417	N=99741.089647
105	E=50286.463231	N=99731.159635
105a	E=50250.093827	N=99737.981471
105b	E=50244.648063	N=99709.691187
105c	E=50203.268323	N=99717.659668
106a	E=50198.213674	N=99723.884252
107	E=50174.442340	N=99724.244950
108	E=50159.107204	N=99715.475928
109	E=50154.599147	N=99712.302923
110	E=50108.239083	N=99703.682556

Highways (Port River Expressway Project) Variation Regulations 2009
Variation of *Highways (Port River Expressway Project) Regulations 2004*—Part 2

Point No	Coordinates	
111	E=50046.075900	N=99691.714142
112	E=50028.602764	N=99688.100827
113	E=50027.638188	N=99848.500883
114	E=50001.664598	N=99905.791924
115	E=49999.674656	N=99924.335069
116	E=49997.679888	N=99999.913661
117	E=49998.357984	N=100030.972905
118	E=49996.586191	N=100098.089430
118a	E=49995.142243	N=100113.646551
119	E=49996.386261	N=100119.996601
120	E=50036.074576	N=100122.082486
121	E=50041.160134	N=99934.466838
122	E=50090.587366	N=99861.733627
123	E=50224.384159	N=99816.926959
123a	E=50315.247147	N=99843.774857
124a	E=50398.932920	N=99836.554069
125	E=50399.928215	N=99848.448341
126	E=50278.294332	N=99985.504017
127	E=50232.149457	N=100276.925848

Note—

As required by section 10AA(2) of the *Subordinate Legislation Act 1978*, the Minister has certified that, in the Minister's opinion, it is necessary or appropriate that these regulations come into operation as set out in these regulations.

Made by the Governor

with the advice and consent of the Executive Council
on 10 December 2009

No 296 of 2009

MTR09/091