

South Australia

Liquor Licensing (Dry Areas—Short Term) Regulations 1997

under the *Liquor Licensing Act 1997*

Contents

- 1 Short title
- 3 Interpretation
- 4 Short term dry areas (section 131 of the Act)
- 5 Plans of short term dry areas

Schedule 1—Short term dry areas

Schedule 2—Plans of short term dry areas

Legislative history

1—Short title

These regulations may be cited as the *Liquor Licensing (Dry Areas—Short Term) Regulations 1997*.

3—Interpretation

- (1) In these regulations, unless the contrary intention appears—
 - the Act* means the *Liquor Licensing Act 1997*;
 - container* means the container in which liquor is sealed so that it cannot escape but does not include packaging in which the container is sold;
 - private land* means any land that is not a public place within the meaning of the Act;
 - street or road* includes an avenue, terrace, lane, crescent, court, place or other land set aside for the carriage of vehicular traffic.
- (2) Unless the contrary intention appears, a reference in these regulations to a street or a road is a reference to—
 - (a) the carriageway of the street or road; and
 - (b) the footpaths (if any) of the street or road; and
 - (c) a median strip or traffic island (if any) or any other land separating carriageways of the street or road; and
 - (d) any other land adjoining or adjacent to the carriageway of the street or road being land that has been reserved for the purposes of the street or road.
- (3) For the purposes of these regulations, a wine cask will be taken to have been opened if the tap comprising part of the container is protruding through the external carton.

4—Short term dry areas (section 131 of the Act)

- (1) Subject to subregulation (2), the consumption of liquor or the consumption and possession of liquor are prohibited in accordance with Schedule 1 in the areas described in that Schedule during the periods specified in that Schedule.
- (2) The prohibition does not extend to any private land within an area described in Schedule 1.
- (3) Unless the contrary intention appears, the prohibition in Schedule 1 of the possession of liquor in an area does not extend to—
 - (a) a person who is genuinely passing through the area if—
 - (i) the liquor is in the original container in which it was purchased from licensed premises; and
 - (ii) the container has not been opened; or
 - (b) a person who has possession of the liquor in the course of carrying on a business or in the course of his or her employment by another person in the course of carrying on a business; or
 - (c) a person who is permanently or temporarily residing at premises within the area or on the boundary of the area and who enters the area solely for the purpose of passing through it to enter those premises or who enters the area from those premises for the purpose of leaving the area; or
 - (d) such other persons (if any) who are specifically excluded by Schedule 1.

5—Plans of short term dry areas

- (1) Schedule 2 sets out plans of some of the areas described in Schedule 1.
- (2) If the description of an area in Schedule 1 does not coincide with the plan of the area in Schedule 2, the description will be taken to be correct.

Schedule 1—Short term dry areas

Area	Period	Extent of prohibition
Adelaide—Area 1 (Ellis Park)		
(there is no plan for this area)		
The area in and adjacent to the City of Adelaide bounded on the north by the southern boundary of Glover Avenue, on the east by the western boundary of West Terrace, on the south by the northern boundary of Sir Donald Bradman Drive and on the west by the eastern boundary of the railway corridor that extends from the northern boundary of Sir Donald Bradman Drive to the southern boundary of Glover Avenue (being the eastern boundary of Lot 17 of Filed Plan No. 1485).	4 pm on 14 January 2011 to 1 am on 16 January 2011.	The consumption of liquor is prohibited and the possession of liquor is prohibited.
Adelaide—Area 2 (Elder Park)		
(see Schedule 2: Adelaide—Plan 1)		
The area in the City of Adelaide bounded as follows: commencing at the point at which a straight line by the shortest route between the north-eastern corner of the Adelaide Festival Centre built structures and the north-western corner of Government House intersects the western boundary of King William Road, then northerly along that boundary of King William Road to the southern boundary of War Memorial Drive, then generally south-westerly, north-westerly and westerly along that boundary of War Memorial Drive to the eastern boundary of Montefiore Road, then southerly along that boundary of Montefiore Road to the northernmost boundary of Festival Drive, then easterly along that boundary of Festival Drive to the point at which it meets the northernmost boundary of the built structures comprising and adjacent to the Adelaide Convention Centre Complex, Hyatt Hotel and Adelaide Festival Centre, then generally easterly, northerly and easterly along that boundary to the north-eastern corner of the Adelaide Convention Centre built structures, then south-easterly along a straight line by the shortest route joining that corner with the north-western corner of Government House to the point of commencement.	6 pm on 31 December 2010 to 6 am on 1 January 2011.	The consumption of liquor is prohibited and the possession of liquor is prohibited.
Adelaide—Area 3 (Rymill Park and Rundle Park)		
(there is no plan for this area)		
The area in the City of Adelaide bounded on the north by Botanic Road, on the east by Dequetteville Terrace, on the south by Bartels Road and on the west by East Terrace. The area includes the whole of Rundle Road between East Terrace and Dequetteville Terrace.	5 am on 1 January 2011 to 12.01 am on 2 January 2011.	The consumption of liquor is prohibited and the possession of liquor is prohibited.

Liquor Licensing (Dry Areas—Short Term) Regulations 1997—9.12.2010 to 15.12.2010

Schedule 1—Short term dry areas

Area	Period	Extent of prohibition
Adelaide—Area 4 (Rymill Park) (there is no plan for this area) The area in the City of Adelaide generally known as Rymill Park, being the area bounded by Rundle Road, Dequetteville Terrace, Bartels Road and East Terrace.	5 pm on 18 February 2011 to 11.59 pm on 20 February 2011.	The consumption of liquor is prohibited and the possession of liquor is prohibited.
Alexandrina Council—Area 1 (Chiton Rocks) (there is no plan for this area) The area adjacent to Victor Harbor generally known as the Chiton Rocks Surf Lifesaving Club car park and the adjacent beach, being the area bounded on the north by the northern boundaries of Lot 469 DP 3482 and Lot 440 DP 3207, on the west by the prolongation in a straight line of the western boundary of Lot 433 DP 3207, on the south by the low water mark on Encounter Bay and on the east by the prolongation in a straight line of the eastern boundary of Lot 463 DP 3482.	6 pm on 30 December 2010 to 6 am on 2 January 2011.	The consumption of liquor is prohibited and the possession of liquor is prohibited.
Alexandrina Council—Area 2 (Port Elliot) (see Schedule 2: Alexandrina Council—Plan 2) The area in and adjacent to Port Elliot bounded as follows: commencing at the point at which the eastern boundary of Lot 26 of DP 74300 meets the northern boundary of Railway Terrace (approximately 50 metres west of the western boundary of Bennett Road), then easterly along the northern boundary of Railway Terrace to the western boundary of Carfax Street, then northerly along that boundary of Carfax Street to the point at which it is intersected by the prolongation in a straight line of the northern boundary of Battunga Avenue, then generally easterly, south-easterly and easterly along that prolongation and boundary of Battunga Avenue and the prolongation in a straight line of that boundary to the eastern boundary of Rosetta Terrace, then southerly along that boundary of Rosetta Terrace to the northern boundary of Barbara Street, then easterly along that boundary of Barbara Street to the point at which it intersects the eastern boundary of Hutton Street, then southerly along that boundary of Hutton Street to the northern boundary of Merrilli Place, then easterly along that boundary of Merrilli Place to the point at which it is intersected by the prolongation in a straight line of the eastern boundary of The Esplanade, then south-easterly along that prolongation and boundary of The Esplanade to the western boundary of Lot 101 of DP 46201, then south-easterly and easterly along that boundary of Lot 101 and the southern boundaries of the adjoining Lots to the western boundary of The Strand, then northerly along that boundary of The	6 pm on 30 December 2010 to 6 am on 2 January 2011.	The consumption of liquor is prohibited and the possession of liquor is prohibited.

Area	Period	Extent of prohibition
<p>Strand to the point at which it intersects the southern boundary of Torrens Street, then in a straight line by the shortest route (across The Strand) to the point at which the southern boundary of Murray Place meets the eastern boundary of The Strand, then easterly and north-easterly along that boundary of Murray Place to the point at which it meets the prolongation in a straight line of the southern boundary of Freeling Street, then north-easterly along that prolongation of the southern boundary of Freeling Street to the point at which it intersects the low water mark of Horseshoe Bay, then generally south-westerly, south-easterly, south-westerly and westerly along the low water mark to the point at which the low water mark is intersected by the prolongation in a straight line of the eastern boundary of Lot 26 of DP 74300, then northerly along that prolongation of the eastern boundary of Lot 26 to the point of commencement. The area includes the whole of any wharf, jetty, boat ramp, breakwater or other structure that projects below the low water mark from within the area described above (as well as any area beneath such a structure).</p> <p>Alexandrina Council—Area 3 (Middleton)</p> <p>(see Schedule 2: Alexandrina Council—Plan 3)</p> <p>Commencing at the south-west corner of Section 2303 Hundred of Goolwa then in a north-easterly and northerly direction along the south-eastern and eastern boundaries of Section 2303 to the intersection with the projection of the northern boundary of lot 1 in filed plan 2100, then easterly and south-easterly along that projection and the northern and north-eastern boundary of lot 1 and the northern boundary of lot 101 in deposited plan 10654, then southerly along the eastern boundary of lot 101 to the south-western corner of lot 19 in deposited plan 3145, then generally north-easterly along the northern boundary of Ocean Parade to the western corner of lot 10 in deposited plan 3262, then northerly along the western boundary of Mill Terrace to the north-eastern corner of lot 39 in deposited plan 3262, then in a straight line to the north-western corner of the reserve lot 160 in deposited plan 9417, then in an easterly direction along the southern boundary of the Esplanade to lot 3 in deposited plan 13398, then along the western, northern and eastern boundaries of that lot to its south-eastern corner, then along the northern boundary of Section 345 to its intersection with the projection of the eastern boundary to lot 39 in deposited plan 6156, then southerly along that projection to the high water line, then generally westerly along the high water line to its intersection with the projection of the western boundary of Section 2303 then northerly along the projection to the point of commencement.</p> <p>Alexandrina Council—Area 4 (Goolwa Beach Carpark)</p> <p>(see Schedule 2: Alexandrina Council—Plan 4)</p> <p>Commencing at the north-eastern corner of Section 279, Hundred of Goolwa, then in a westerly and</p>	<p>6 pm on 30 December 2010 to 6 am on 2 January 2011.</p> <p>6 pm on 30 December 2010</p>	<p>The consumption of liquor is prohibited and the possession of liquor is prohibited.</p> <p>The consumption of liquor is</p>

Liquor Licensing (Dry Areas—Short Term) Regulations 1997—9.12.2010 to 15.12.2010

Schedule 1—Short term dry areas

Area	Period	Extent of prohibition
southerly direction along the northern and western boundaries of Section 279, then in a southerly and easterly direction along the western and southern boundaries of Section 367, Hundred of Goolwa to the south-eastern corner of Section 367, then in a straight line across Goolwa Beach Road to the south-western corner of Section 368, Hundred of Goolwa, then in an easterly and northerly direction along the southern and eastern boundaries of Section 368, then in a northerly and westerly direction along the eastern and northern boundaries of Section 278, Hundred of Goolwa to the north-western corner of Section 278, then in a straight line across Goolwa Beach Road to the point of commencement.	to 6 am on 2 January 2011.	prohibited and the possession of liquor is prohibited.
Alexandrina Council—Area 5 (Rotunda Reserve Area)		
(see Schedule 2: Alexandrina Council—Plan 5)		
Commencing at the northern corner of lot 167 then in a south-easterly direction along the north-eastern boundaries of lots 167, 171, 175 and 179 and the projection of that line across Hay Street to the boundary of part Section 271, then north-easterly along the north-western boundaries of part Section 271 and lot 2 in file plan 11114 and the projection of that line across The Cutting Road to the boundary of lot 3 in filed plan 11114, then north-westerly along the south-western boundary of part Section 271 and lot 190 then north-easterly along the north-western boundary of lot 190 and the projection of that boundary to the centre line of B.F. Laurie Lane, then north-westerly along the projection of the centreline to its intersection with the projection of the south-eastern boundary of lot 156, then south-westerly along that projection and boundary to the boundary of Section 215, then north-westerly along the boundary of Section 215 to its intersection with the boundary between lot 139 and Dawson Street then north-westerly along that boundary to the western corner of lot 139 then in a straight line across Section 215 to the point at which the boundary between lot 138 and Porter Street changes direction, then south-easterly along the north-eastern boundaries of lots 138, 147 and 155 and the projection of that boundary across Wildman Street to the northern corner of lot 166, then across Porter Street to the western corner of lot 167 then along the north-western boundary of lot 167 to the point of commencement.	6 pm on 30 December 2010 to 6 am on 2 January 2011.	The consumption of liquor is prohibited and the possession of liquor is prohibited.
Alexandrina Council—Area 6 (Basham Beach Area)		
(see Schedule 2: Alexandrina Council—Plan 6)		
Commencing at the point at which the western boundary of Basham Beach Road, Middleton, intersects the southern boundary of the railway reserve for the Victor Harbor Tourist Railway, then south-easterly along that boundary of Basham Beach Road to the northern boundary of Lot 96 FP 166155, then south-westerly, south-easterly and north-easterly along the northern, western and southern boundaries of Lot 96 to the western boundary of Basham Beach Road, then south-easterly	6 pm on 30 December 2010 to 6 am on 2 January 2011.	The consumption of liquor is prohibited and the possession of liquor is prohibited.

Area	Period	Extent of prohibition
<p>along that boundary of Basham Beach Road and the prolongation in a straight line of that boundary to the low water mark of Encounter Bay, then generally south-westerly, southerly, south-easterly, easterly, southerly, south-westerly and north-westerly along the low water mark to the prolongation in a straight line of the western boundary of Lot 2 DP 52281, then northerly along that prolongation and boundary of Lot 2 to the southern boundary of Lot 1 DP 52281 (the southern boundary of the Port Elliot Caravan Park), then generally easterly, south-easterly, north-easterly and northerly along that boundary of Lot 1 and the eastern boundary of Lot 858 FP 166107 to the northern boundary of Lot 858, then south-westerly along the northern boundary of Lot 858 and the northern boundaries of the adjoining allotments to the eastern boundary of the railway reserve for the Victor Harbor Tourist Railway, then generally north-easterly along that boundary of the railway reserve to the point of commencement.</p> <p>Beachport—Area 1</p> <p>(see Schedule 2: Beachport—Plan 1)</p> <p>The area hatched in Beachport—Plan 1 in Schedule 2.</p>	<p>12 noon on 31 December 2010 to 12 noon on 2 January 2011.</p>	<p>The consumption of liquor is prohibited and the possession of liquor is prohibited.</p>
<p>Coffin Bay—Area 1</p> <p>(see Schedule 2: Coffin Bay—Plan 1)</p> <p>The area in and adjacent to the town of Coffin Bay bounded as follows: commencing at the point at which the prolongation in a straight line of the northern boundary of Section 665 Hundred of Lake Wangary intersects the low water mark of Coffin Bay, then generally northerly, easterly, southerly, south-easterly and north-easterly along the low water mark to the point at which it is intersected by the prolongation in a straight line of the western boundary of Section 131 Hundred of Lake Wangary, then southerly along that prolongation and boundary of Section 131 to the northern boundary of Lot 57 DP 54186, then generally south-westerly and south-easterly along the northern and south-western boundaries of Lot 57 to the point at which the south-western boundary is intersected by the prolongation in a straight line of the north-western boundary of Section 273 Hundred of Lake Wangary, then south-westerly along that prolongation and boundary of Section 273 to the point at which it meets the eastern boundary of Section 295 Hundred of Lake Wangary, then south-westerly, north-westerly, north-easterly and north-westerly along the north-eastern and northern boundaries of Section 295 to the western boundary of the Section, then southerly along the western boundaries of Section 295, Lots 212 and 211 of DP 71703, Lot 101 of DP 56785 and Lot 6</p>	<p>5 pm on 31 December 2010 to 9 am on 1 January 2011.</p>	<p>The consumption of liquor is prohibited and the possession of liquor is prohibited.</p>

Liquor Licensing (Dry Areas—Short Term) Regulations 1997—9.12.2010 to 15.12.2010

Schedule 1—Short term dry areas

Area	Period	Extent of prohibition
<p>DP 25759 to the northern boundary of Section 665 Hundred of Lake Wangary, then generally westerly, north-westerly, northerly and westerly along the northern boundary of that Section to the point at which it meets the eastern boundary of Section 667 Hundred of Lake Wangary, then westerly along the northern boundary of Section 667, the northern boundary of Section 665 Hundred of Lake Wangary and the prolongation in a straight line of the northern boundary of Section 665 to the point of commencement. The area includes the whole of any jetty, boat ramp or other structure that projects below the low water mark from within the area described above (as well as any area beneath such a structure).</p>		
<p>Glenelg—Area 1</p>		
<p>(see Schedule 2: Glenelg—Plan 1)</p>		
<p>The area in Glenelg bounded as follows: commencing at the point at which the eastern boundary of Colley Terrace intersects the northern boundary of Augusta Street, then generally easterly along the northern boundary of Augusta Street (including around the western, northern and eastern boundaries of Torrens Square) to its intersection with the eastern boundary of Brighton Road, then southerly along that boundary of Brighton Road to the northern boundary of Dunbar Terrace, then easterly along that boundary of Dunbar Terrace to the point at which it meets the western boundary of First Avenue, then in a straight line by the shortest route (across Dunbar Terrace and Maxwell Terrace) to the point at which the southern boundary of Maxwell Terrace meets the eastern boundary of Fortrose Street, then westerly along that boundary of Maxwell Terrace to the eastern boundary of Brighton Road, then southerly along that boundary of Brighton Road to its intersection with the prolongation in a straight line of the southern boundary of High Street, then generally westerly along that prolongation and boundary of High Street to the point at which the prolongation in a straight line of that southern boundary of High Street intersects the western boundary of Moseley Street, then northerly along that boundary of Moseley Street to the southern boundary of College Street, then westerly along that boundary of College Street and the prolongation in a straight line of that boundary to the western boundary of St John's Row, then northerly along that boundary of St John's Row to the southern boundary of South Esplanade Lane (the northern boundary of Lot 101 FP 6859), then westerly along that boundary of South Esplanade Lane to the eastern boundary of the South Esplanade, then south-westerly along that boundary of the South Esplanade to the northern boundary of Kent Street, then westerly along that boundary of Kent Street and the prolongation in a straight line of that boundary to the low water mark of Gulf St Vincent, then generally northerly along the low water mark (including the low water mark around the outer boundary of any breakwater or groyne) to the entrance to the Patawalonga River, then generally south-easterly, easterly, northerly, easterly and northerly along the southern and eastern bank of the River to the point at which the eastern bank of the River intersects the prolongation in a straight line</p>	<p>9 pm on 31 December 2010 to 6 am on 1 January 2011.</p>	<p>The consumption of liquor is prohibited. The possession of liquor is prohibited, and the prohibition extends to possession in each of the circumstances referred to in regulation 4(3).</p>

Area	Period	Extent of prohibition
<p>of the southern boundary of St Anne's Terrace, then easterly along that prolongation to the western boundary of Adelphi Terrace, then southerly along that western boundary of Adelphi Terrace and the prolongation in a straight line of that boundary to the southern boundary of Anzac Highway, then westerly along that boundary of Anzac Highway to the eastern boundary of Colley Terrace, then southerly along that boundary of Colley Terrace to the point of commencement. The area includes the Glenelg Jetty and any other jetty, wharf, mooring, dock or other structure (apart from the Patawalonga Weir) projecting into the Gulf or River from the area described above, as well as any area beneath such a structure.</p> <p>Morgan—Area 1</p> <p>(there is no plan for this area)</p> <p>The area in Morgan bounded as follows: commencing at the point at which the prolongation in a straight line of the southern boundary of Section 432 Hundred of Eba intersects the waterline on the north-western side of the River Murray, then generally north-westerly, westerly and north-westerly along that prolongation and boundary of Section 432 to the south-eastern boundary of Railway Terrace, then generally north-easterly along that south-eastern boundary of Railway Terrace to the point at which it meets the northern corner of Section 484 Hundred of Eba, then generally north-easterly along the north-western boundary of Section 433 Hundred of Eba to the northernmost boundary of Section 429 Hundred of Eba, then north-easterly along that boundary of Section 429 and the prolongation in a straight line of that boundary to the waterline on the north-western side of the River Murray, then generally south-westerly along the waterline of the River to the point of commencement, but excluding Sections 483, 484 and 485 Hundred of Eba.</p> <p>Murray Bridge—Area 1</p> <p>(see Schedule 2: Murray Bridge—Plan 1)</p> <p>The area in Murray Bridge, comprising Sturt Reserve and adjacent areas, bounded as follows: commencing at the point at which the south-eastern boundary of Bridge Street meets the south-western edge of the River Murray, then generally south-easterly along that edge of the River to the point at which it intersects the prolongation in a straight line of the south-eastern boundary of the southern portion of Jaensch Road, then generally south-westerly, westerly and north-westerly along that prolongation and boundary of the southern portion of Jaensch Road and the prolongation in a straight line across Sturt Reserve Road of that boundary to the north-western boundary of Sturt Reserve Road, then north-easterly along that boundary of Sturt Reserve Road to the western boundary of Lot 82 DP55455, then generally north-westerly and north-easterly along that boundary of Lot 82 to the western boundary of the northern portion of Jaensch Road, then generally north-</p>	<p>4 pm on 31 December 2010 to 9 am on 1 January 2011.</p> <p>5 p.m. on 18 November 2006 to 12 midnight on 18 November 2006.</p>	<p>The consumption of liquor is prohibited and the possession of liquor is prohibited.</p> <p>The consumption of liquor is prohibited and the possession of liquor is prohibited.</p>

Liquor Licensing (Dry Areas—Short Term) Regulations 1997—9.12.2010 to 15.12.2010

Schedule 1—Short term dry areas

Area	Period	Extent of prohibition
<p>easterly and north-westerly along that boundary of the northern portion of Jaensch Road and the south-western boundary of East Terrace to the point at which the south-western boundary of East Terrace meets the south-eastern boundary of Bridge Street, then generally north-easterly along that boundary of Bridge Street to the point of commencement. The area includes any wharf, jetty, boat ramp or other structure (other than a bridge across the River) extending into or over the waters of the River Murray from the area described above.</p> <p>Port Augusta—Area 1</p> <p>(see Schedule 2: Port Augusta—Plan 1)</p> <p>The area in Port Augusta, generally known as Central Oval, that is enclosed by a fence that, from the point at which the northern boundary of the Port Augusta TAFE SA Campus meets the north-eastern boundary of Victoria Parade, proceeds generally easterly, north-easterly, northerly, north-westerly, westerly, south-westerly and south-easterly (around the oval and trotting track that lies immediately to the north of the TAFE SA Campus and along the north-eastern boundary of Victoria Parade) back to the point of commencement.</p> <p>Port Vincent—Area 1</p> <p>(see Schedule 2: Port Vincent—Plan 1)</p> <p>The area in Port Vincent bounded as follows: commencing at the point at which the south-western boundary of Marine Parade meets the south-eastern boundary of Way Street, then south-easterly along that boundary of Marine Parade to the point at which it meets the south-eastern boundary of Curramulka Road, then north-easterly along the prolongation in a straight line of that boundary of Curramulka Road to the north-eastern boundary of Marine Parade, then south-easterly along that road boundary to the eastern boundary of Lot 7 (the western boundary of the entrance to the boat ramp), then northerly along that boundary of Lot 7 and the prolongation in a straight line of that boundary to the low water mark of Gulf St. Vincent, then generally north-westerly along the low water mark and around the outer boundary of any wharf or other structure extending into Gulf St. Vincent beyond the low water mark (so as to include the wharf or other structure within the area) to the point at which the low water mark intersects the prolongation in a straight line of the south-eastern boundary of Way Street, then south-westerly along that prolongation and boundary to the point of commencement, together with—</p> <p>(a) Cameron Street between the south-western boundary of Marine Parade and the south-western boundary of Germein Street; and</p> <p>(b) Germein Street between the north-western boundary of Cameron Street and north-western</p>	<p>12.01 a.m. on 1 October 2005 to 12.01 a.m. on 4 October 2005.</p> <p>10 p.m. on each day to 8 a.m. on the following day, from 10 p.m. on 22 December 2007 to 8 a.m. on 2 January 2008.</p>	<p>The consumption of liquor is prohibited and the possession of liquor is prohibited.</p> <p>The consumption of liquor is prohibited and the possession of liquor is prohibited.</p>

Area	Period	Extent of prohibition
<p>boundary of Main Street; and</p> <p>(c) Main Street between the south-western boundary of Germein Street and the south-western boundary of Marine Parade; and</p> <p>(d) Ramsay Street between the south-eastern boundary of Main Street and the south-eastern boundary of Curramulka Road; and</p> <p>(e) Curramulka Road between the south-western boundary of Ramsay Street and the south-western boundary of Marine Parade.</p>		

Robe—Area 1

(see Schedule 2: Robe—Plan 1)

The area in and adjacent to Robe, comprising Lipson Park, Lipson Terrace, Royal Circus Reserve and other land, bounded as follows: commencing at the point at which the eastern boundary of Hagen Street intersects the northern boundary of Sturt Street, then westerly along that boundary of Sturt Street and the prolongation in a straight line of that boundary to the point at which it intersects the eastern boundary of Lot 154 of DP 3890, then north-easterly along that boundary of Lot 154, the eastern boundaries of Lot 104 of DP 59573 and Piece 93 of FP 200392, and the prolongation in a straight line of the eastern boundary of Piece 93 to the low water mark of Lake Butler, then north-easterly along the low water mark of Lake Butler to the point at which it is intersected by the prolongation in a straight line of the western boundary of the car parking area on Lipson Terrace at the northern end of the Terrace (the western boundary of the car parking area being the western boundary of the Lipson Terrace road reserve and indicated by a line of bollards), then north-easterly and easterly along that prolongation and boundary of the Lipson Terrace car parking area and of Lipson Terrace to the eastern boundary of Lot 103 of FP 215001, then southerly along the prolongation in a straight line of that boundary of Lot 103 to the northern kerb line of Lipson Terrace, then easterly and south-easterly along the northern kerb line of Lipson Terrace and of the northernmost part of Royal Circus to the point at which that kerb line is intersected by the prolongation in a straight line of the easternmost boundary of Royal Circus (the western boundary of Lot 1 of TP 441801), then southerly along that prolongation to the easternmost boundary of Royal Circus, then south-westerly, westerly and north-westerly around the easternmost, southern and westernmost boundaries of Royal Circus back to the point at which the westernmost boundary of Royal Circus meets the southern boundary of Lipson Terrace, then generally westerly, south-westerly and southerly along that boundary of Lipson Terrace and of Hagen Street to the point of commencement.

1 pm on 31 December 2010
to 9 am on 2 January 2011.

The consumption of liquor is prohibited and the possession of liquor is prohibited.

Liquor Licensing (Dry Areas—Short Term) Regulations 1997—9.12.2010 to 15.12.2010

Schedule 1—Short term dry areas

Area	Period	Extent of prohibition
Robe—Area 2 (see Schedule 2: Robe—Plan 1) <p>The area in and adjacent to Robe, comprising the areas generally known as Town Beach, Foreshore Reserve (from Robe Point to Town Beach), Institute Reserve and other land, bounded as follows: commencing at the point at which the southern boundary of Mundy Terrace meets the easternmost boundary of Royal Circus, then northerly along the prolongation in a straight line of the easternmost boundary of Royal Circus (the western boundary of Lot 1 of TP 441801) to the kerb line on the northern side of Mundy Terrace, then north-westerly and westerly along that kerb line of Mundy Terrace, the northernmost part of Royal Circus and of Lipson Terrace to the point at which the northern kerb line of Lipson Terrace is intersected by the prolongation in a straight line of the eastern boundary of Lot 103 of FP 215001, then northerly along that prolongation and boundary of Lot 3 to the south-eastern boundary of Lot 2 of DP 33446, then north-easterly along that boundary of Lot 2 to the south-western boundary of Lot 3 of DP 33446, then north-westerly and north-easterly along the south-western and north-western boundaries of Lot 3 and the prolongation in a straight line of the north-western boundary of Lot 3 to the low water mark of Guichen Bay, then generally easterly, south-easterly and north-easterly along the low water mark to the point at which it is intersected by the prolongation in a straight line of the eastern boundary of Lot 51 of DP 52016, then southerly along that prolongation of the eastern boundary of Lot 51 to the northern boundary of Lot 51, then westerly and south-westerly along the northern boundary of Lot 51 and the northern boundaries of the adjoining allotments to the western boundary of Lot 11 of FP 105311, then in a straight line by the shortest route to the north-eastern corner of the fence bounding the bowling greens situated on the south-eastern corner of Section 526, Hundred of Waterhouse, then westerly and south-westerly along that fence line to the north-eastern boundary of Mundy Terrace, then in a straight line by the shortest route across Mundy Terrace to the south-western boundary of Mundy Terrace, then south-easterly along that boundary of Mundy Terrace to the northern boundary of Smillie Street, then westerly along that boundary of Smillie Street to the eastern boundary of Bagot Street, then northerly along that boundary of Bagot Street back to the south-western boundary of Mundy Terrace, then generally north-westerly and westerly along that boundary of Mundy Terrace to the point of commencement.</p>	12.01 am on 26 December 2010 to 11.59 pm on 8 January 2011.	The consumption of liquor is prohibited and the possession of liquor is prohibited.
Robe—Area 3 (see Schedule 2: Robe—Plan 1) <p>The area in Robe, generally known as Lannam Park, bounded on the south by Main Road, on the east by the prolongation in a straight line of the eastern boundary of Robson Street, on the north by</p>	1 pm on 31 December 2010 to 9 am on 2 January 2011.	The consumption of liquor is prohibited and the

Area	Period	Extent of prohibition
Ryan Terrace and on the west by Domaschenz Street.		possession of liquor is prohibited.
Robe—Area 4		
(see Schedule 2: Robe—Plan 2)		
The area adjacent to Robe, generally known as Long Beach Foreshore Reserve, bounded as follows: commencing at the point at which the prolongation in a straight line of the western boundary of Laurel Terrace intersects the low water mark of Guichen Bay, then southerly along that prolongation to the northern boundary of the Esplanade, then generally south-westerly along that boundary of the Esplanade to the western boundary of Section 523, Hundred of Waterhouse, then north-westerly along that boundary and the prolongation in a straight line of that boundary to the low water mark of Guichen Bay, then generally north-easterly along the low water mark to the point of commencement.	1 pm on 31 December 2010 to 9 am on 2 January 2011.	The consumption of liquor is prohibited and the possession of liquor is prohibited.
Semaphore—Area 1		
(there is no plan for this area)		
Semaphore Road (in Semaphore and Exeter) between the eastern boundary of the Esplanade and the prolongation in a straight line of the marked centre line of Causeway Road.	(a) 12 noon on 31 December 2010 to 12 noon on 1 January 2011;	The consumption of liquor is prohibited and the possession of liquor is prohibited.
	(b) 12 noon on 26 January 2011 to 12 noon on 27 January 2011.	
Spalding—Area 1		
(see Schedule 2: Spalding—Plan 1)		
The area at Spalding bounded as follows: commencing at the point at which the southern boundary of Davies Terrace meets the eastern boundary of the Spalding to Clare Road, then in a straight line by the shortest route (across the Spalding to Clare Road) to the point at which the southern boundary of Trelyn Road meets the western boundary of the Spalding to Clare Road, then generally north-westerly and northerly along that boundary of Trelyn Road to the point at which it meets the southern boundary of the Jamestown to Spalding Road, then in a straight line by the shortest route (across the Jamestown to Spalding Road) to the point on the northern boundary of the Jamestown to	12 noon on 27 November 2010 to 12 noon on 28 November 2010.	The consumption of liquor is prohibited and the possession of liquor is prohibited.

Liquor Licensing (Dry Areas—Short Term) Regulations 1997—9.12.2010 to 15.12.2010

Schedule 1—Short term dry areas

Area	Period	Extent of prohibition
<p>Spalding Road at which the western boundary of Lot 538 of Filed Plan No. 187050 meets the northern boundary of Lot 537 of Filed Plan No. 187049, then easterly, southerly, easterly and north-easterly along the southern and eastern boundaries of Lot 538 to the point at which the eastern boundary of that Lot (the western boundary of Main Street) intersects the prolongation in a straight line of the northern boundary of Lincoln Avenue, then south-easterly along that prolongation and boundary of Lincoln Avenue and the prolongation in a straight line of that boundary to the point at which it intersects the eastern boundary of Edgeware Avenue, then south-westerly along that boundary of Edgeware Avenue to the point at which it meets the northern boundary of Howley's Crossing Road, then generally south-easterly, north-easterly and southerly along that boundary of Howley's Crossing Road and the prolongation in a straight line of that boundary to the southern boundary of Borve Hill Road, then south-westerly and westerly along that boundary of Borve Hill Road to the eastern boundary of the Burra to Spalding Road, then in a straight line by the shortest route (across the Burra to Spalding Road) to the point at which the southern boundary of Davies Terrace meets the western boundary of the Burra to Spalding Road, then north-westerly along that southern boundary of Davies Terrace to the point of commencement.</p>		
<p>Stirling—Area 1</p>		
<p>(there is no plan for this area)</p>		
<p>The area in and adjacent to Stirling bounded as follows: commencing at the point at which the prolongation in a straight line of the eastern boundary of Gould Road intersects the northern boundary of Old Mount Barker Road, then generally south-westerly along that prolongation and boundary of Gould Road, the eastern boundary of Twin Street and the prolongation in a straight line of the eastern boundary of Twin Street to the south-western boundary of Milan Terrace, then generally north-westerly along that boundary of Milan Terrace and of Ayers Hill Road to the point at which the south-western boundary of Ayers Hill Road is intersected by the prolongation in a straight line of the northern boundary of Braemar Terrace, then generally north-easterly and northerly along that prolongation and boundary of Braemar Terrace to the point at which it meets the southern boundary of Devon Avenue, then in a straight line by the shortest route to the point at which the south-western boundary of Melrose Avenue meets the northern boundary of Devon Avenue, then north-easterly along the prolongation in a straight line of the northern boundary of Devon Avenue to the eastern boundary of Glenside Road, then southerly along that boundary of Glenside Road to the north-western boundary of Ackland Avenue, then north-easterly along that boundary of Ackland Avenue and the prolongation in a straight line of that boundary (approximately parallel to the north-western boundary of the South-Eastern Freeway) to the point at which that prolongation intersects the north-eastern boundary of Old Mount Barker Road, then generally south-easterly and easterly along that boundary of Old Mount Barker Road to the point of</p>	<p>12 noon on 5 November 2010 to 12 noon on 6 November 2010.</p>	<p>The consumption of liquor is prohibited and the possession of liquor is prohibited.</p>

Area	Period	Extent of prohibition
commencement.		
Streaky Bay—Area 1		
(there is no plan for this area)		
The area in and adjacent to the town of Streaky Bay bounded as follows: commencing at the point at which the prolongation in a straight line of the western boundary of Linklater Street intersects the low water mark of Streaky Bay, then generally easterly along the low water mark to the point at which it is intersected by the prolongation in a straight line of the eastern boundary of Burke Street, then south-easterly along that prolongation and boundary of Burke Street to the northern boundary of the Flinders Highway, then easterly along that boundary of the Flinders Highway to the western boundary of Hospital Drive, then in a straight line by the shortest route (across the Flinders Highway) to the point at which the western boundary of East Terrace meets the southern boundary of the Flinders Highway, then south-easterly along the western boundary of East Terrace to the point at which it intersects the south-western boundary of Mudge Terrace, then north-westerly along the south-western boundary of Mudge Terrace to the point at which it meets the southern boundary of Wells Street, then generally south-westerly and westerly along the southern boundary of Wells Street to the point at which it intersects the western boundary of Linklater Street, then northerly along the western boundary of Linklater Street and the prolongation in a straight line of that boundary to the point of commencement. The area includes the whole of any jetty, boat ramp or other structure that projects below the low water mark from within the area described above (as well as any area beneath such a structure).	6 pm on 31 December 2009 to 8 am on 1 January 2010.	The consumption of liquor is prohibited and the possession of liquor is prohibited.
Tumby Bay—Area 1		
(see Schedule 2: Tumby Bay—Plan 1)		
Commencing at the point at which the prolongation of the northern boundary of Dutton Terrace intersects the low water mark, then south-easterly along the low water mark to its intersection with the prolongation of the southern boundary of Goode Avenue, then south-westerly along the prolongation of the southern boundary of Goode Avenue to its intersection with the western boundary of Tumby Terrace, then north-westerly and northerly along that boundary to its intersection with the northern boundary of Dutton Terrace, then easterly along the prolongation of the northern boundary of Dutton Terrace to the point of commencement.	6.00 p.m. on 10 January 2005 to 6.00 a.m. on 15 January 2005.	The consumption of liquor is prohibited and the possession of liquor is prohibited.

Liquor Licensing (Dry Areas—Short Term) Regulations 1997—9.12.2010 to 15.12.2010

Schedule 1—Short term dry areas

Area	Period	Extent of prohibition
Two Wells—Area 1 (there is no plan for this area) The area in and adjacent to Two Wells comprising Old Port Wakefield Road between Mallala Two Wells Road and Canala Court.	5 pm on 10 December 2010 to 5 am on 11 December 2010.	The consumption of liquor is prohibited and the possession of liquor is prohibited.
Unley—Area 1 (there is no plan for this area) The area in Unley and adjacent suburbs bounded as follows: commencing at the point at which the eastern boundary of Wood Street, Millswood, meets the northern boundary of Jasper Street, then easterly along the northern boundary of Jasper Street to the western boundary of Westall Street, Hyde Park, then northerly along that boundary of Westall Street to the point at which it is intersected by the prolongation in a straight line of the northern boundary of Esmond Street, then easterly along that prolongation and boundary of Esmond Street to the point at which the northern boundary of Esmond Street meets the western boundary of Mann Street, then northerly along that boundary of Mann Street to the southern boundary of Park Street, then easterly along that boundary of Park Street to the point at which it is intersected by the prolongation in a straight line of the western boundary of Russell Street, then northerly along that prolongation and boundary of Russell Street to the southern boundary of Opey Avenue, then in a straight line by the shortest route to the point at which the northern boundary of Thomas Street, Unley, meets the eastern boundary of Queen Street, then northerly along that boundary of Queen Street to the southern boundary of Mary Street, then westerly along that southern boundary of Mary Street and the prolongation in a straight line of that boundary to the point at which it intersects the eastern boundary of Weller Street, Goodwood, then southerly along that eastern boundary of Weller Street and the eastern boundary of Wood Street, Millswood, to the point of commencement.	6 pm on 20 January 2010 to 1 am on 21 January 2010.	The consumption of liquor is prohibited and the possession of liquor is prohibited.
Victor Harbor—Area 1 (see Schedule 2: Victor Harbor—Plan 1) The area in Victor Harbor bounded as follows: commencing at the point at which the north-western boundary of Hindmarsh Road intersects the southern bank of the Hindmarsh River, then along that bank of the Hindmarsh River to the low water mark of Encounter Bay, then generally south-westerly, southerly, westerly and south-westerly along the low water mark to the northern	From 3 pm on 31 December 2010 to 8 am on 1 January 2011.	The consumption of liquor is prohibited and the possession of liquor is prohibited.

Area	Period	Extent of prohibition
<p>bank of the Inman River, then generally westerly along that bank of the Inman River to the eastern boundary of the Victor Harbor Beach Front Caravan Park, then north-easterly along that boundary to the western boundary of Inman Street, then north-westerly along that boundary of Inman Street and the prolongation in a straight line of that boundary to the north-western boundary of Victoria Street, then north-easterly along that boundary of Victoria Street to its intersection with the western boundary of Torrens Street, then north-westerly and north-easterly along that boundary of Torrens Street to its intersection with the north-eastern boundary of Crozier Road, then north-westerly along that boundary of Crozier Road to its intersection with the south-eastern boundary of Acraman Street, then north-easterly along that boundary of Acraman Street and Carlyle Street to its intersection with the south-western boundary of Cornhill Road, then south-easterly along that boundary of Cornhill Road to the north-western boundary of Hindmarsh Road, then generally north-easterly along that boundary of Hindmarsh Road to the point of commencement.</p> <p>Victor Harbor—Area 2</p> <p>(see Schedule 2: Victor Harbor—Plan 2)</p> <p>The area in and adjacent to Victor Harbor bounded as follows: commencing at the point at which the north-western boundary of Hindmarsh Road intersects the southern bank of the Hindmarsh River, then generally westerly, north-easterly and north-westerly along that bank of the Hindmarsh River to the point at which it is intersected by the prolongation in a straight line of the northern boundary of Dinan Road, then easterly along that prolongation and boundary of Dinan Road and the prolongation in a straight line of that boundary to the western boundary of Laxton Street, then generally south-westerly and south-easterly along that boundary of Laxton Street, the south-western boundary of Adare Avenue and the prolongation in a straight line of the south-western boundary of Adare Avenue to the south-eastern boundary of Hindmarsh Road, then generally south-westerly along that boundary of Hindmarsh Road to the point at which it intersects the northern bank of the Hindmarsh River, then along that bank of the Hindmarsh River to the low water mark of Encounter Bay, then generally south-westerly, southerly, westerly and south-westerly along the low water mark to the northern bank of the Inman River, then generally westerly along that bank of the Inman River to the eastern boundary of the Victor Harbor Beach Front Caravan Park, then north-easterly along that boundary to the western boundary of Inman Street, then north-westerly along that boundary of Inman Street and the prolongation in a straight line of that boundary to the north-western boundary of Victoria Street, then north-easterly along that boundary of Victoria Street to the point at which it meets the south-western boundary of George Main Road, then north-westerly along that boundary of George Main Road to the southern boundary of Barker Reserve, then generally westerly along that boundary of the Reserve to the south-eastern boundary of Bay Road, then generally north-easterly along that boundary of Bay Road (the north-western boundary of the Reserve) to the point at which</p>	<p>From 8 am on 19 November 2010 to 10 am on 27 November 2010.</p>	<p>The consumption of liquor is prohibited and the possession of liquor is prohibited.</p>

Liquor Licensing (Dry Areas—Short Term) Regulations 1997—9.12.2010 to 15.12.2010

Schedule 1—Short term dry areas

Area	Period	Extent of prohibition
<p>it meets the outer boundary of the roundabout at the intersection between Bay Road and George Main Road, then generally south-easterly and north-easterly around that boundary of the roundabout to the south-western boundary of George Main Road, then in a straight line by the shortest route across George Main Road to the north-eastern boundary of that road, then north-westerly along that boundary of George Main Road to the point at which the north-eastern boundary of George Main Road meets the eastern boundary of Lot 11 DP 14245 (Victor Harbor High School), then north-easterly, north-westerly, north-easterly, north-westerly and south-westerly along that boundary of Lot 11 to the point at which it meets the south-eastern boundary of Kullaroo Road, then north-easterly along the south-eastern boundary of Kullaroo Road and the prolongation in a straight line of that boundary to the north-eastern boundary of Oval Road, then south-easterly along that boundary of Oval Road to the south-eastern boundary of Lindsay Street, then north-easterly along that boundary of Lindsay Street and the south-eastern boundaries of Acraman Street and Carlyle Street to the point at which the south-eastern boundary of Carlyle Street intersects the south-western boundary of Cornhill Road, then south-easterly along that boundary of Cornhill Road to the north-western boundary of Hindmarsh Road, then generally north-easterly along that boundary of Hindmarsh Road to the point of commencement.</p>		
<p>Victor Harbor—Area 3</p> <p>(there is no plan for this area)</p> <p>The whole of Granite Island (to low water mark) and the whole of the causeway linking Granite Island to the mainland.</p>	<p>(a) From 8 am on 19 November 2010 to 10 am on 27 November 2010;</p> <p>(b) From 3 pm on 31 December 2010 to 8 am on 1 January 2011.</p>	<p>The consumption of liquor is prohibited and the possession of liquor is prohibited.</p>
<p>Wallaroo—Area 1</p> <p>(see Schedule 2: Wallaroo—Plan 1)</p> <p>The area in Wallaroo, generally known as North Beach and Second Beach, bounded as follows: commencing at the point at which the low water mark on the eastern side of Spencer Gulf intersects the northern boundary of Lot 1003 of DP 56470, then southerly along the low water mark to the</p>	<p>12 noon on 31 December 2010 to 7 am on 1 January 2011.</p>	<p>The consumption of liquor is prohibited and the possession of liquor is</p>

Area	Period	Extent of prohibition
<p>northern side of the northern breakwater of the Copper Cove Marina, then westerly, southerly and easterly along the low water mark around the northern, western and southern sides of that northern breakwater and the northern side of the marina to the eastern boundary of Lot 1003 of DP 56470, then northerly along the eastern boundary of Lot 1003 and the eastern boundary of Piece 915 of DP 36451 to the southern boundary of Lot 50 of DP 39503, then westerly, northerly and easterly along the southern, western and northern boundaries of Lot 50 to the point at which the northern boundary meets the eastern boundary of Lot 50 of DP 48403, then generally northerly along the eastern boundary of Lot 50 of DP 48403 to the northern boundary of Lot 50, then westerly along the northern boundary of Lot 50 to the point at which it meets the eastern boundary of Section 1997 Hundred of Wallaroo, then generally northerly along the eastern boundary of Section 1997 (and of Section 2080 Hundred of Wallaroo) to the point at which the eastern boundary of Section 1997 meets the southern boundary of Lot 93 of DP 6222, then easterly along that boundary of Lot 93 to the point at which it meets the western boundary of Lot 1 of DP 6222, then generally north-westerly along the western boundaries of Lot 1 and of the adjoining Lots (including the western boundary of Jonlin Street) to the northern boundary of Lot 12 of DP 6222, then south-westerly along the prolongation in a straight line of that northern boundary of Lot 12 to the low water mark on the eastern side of Spencer Gulf, then generally southerly along the low water mark to the point of commencement.</p>		prohibited.
<p>Wallaroo—Area 2</p> <p>(see Schedule 2: Wallaroo—Plan 2)</p> <p>The area in Wallaroo bounded as follows: commencing at the point at which the northern boundary of Jetty Road meets the eastern boundary of Heritage Drive, then north-easterly along that eastern boundary of Heritage Drive to the point at which it meets the western boundary of Lot 2001 of DP 82762, then generally southerly and south-easterly along that western boundary of Lot 2001 and the western boundary of Lot 2002 of DP 82762 to the point at which that boundary of Lot 2002 meets the north-western boundary of Lot 2005 of DP 82762, then in a straight line by the shortest route to the north-western boundary of Lot 313 of TP 211103, then south-westerly along that boundary of Lot 313 to the northern boundary of Jetty Road, then north-westerly along that boundary of Jetty Road to the point of commencement.</p>	<p>12 noon on 31 December 2010 to 7 am on 1 January 2011.</p>	<p>The consumption of liquor is prohibited and the possession of liquor is prohibited.</p>
<p>Wallaroo—Area 3</p> <p>(see Schedule 2: Wallaroo—Plan 2)</p> <p>The area in Wallaroo bounded as follows: commencing at the point at which the north-eastern boundary of Owen Terrace meets the south-eastern boundary of Emu Street, then in a straight line</p>	<p>12 noon on 31 December 2010 to 7 am</p>	<p>The consumption of liquor is prohibited and the</p>

Liquor Licensing (Dry Areas—Short Term) Regulations 1997—9.12.2010 to 15.12.2010

Schedule 1—Short term dry areas

Area	Period	Extent of prohibition
by the shortest route (across Emu Street) to the point at which the north-western boundary of Emu Street meets the north-eastern boundary of Jetty Road, then generally north-westerly and westerly along that boundary of Jetty Road to the point at which it meets the south-western boundary of Lot 104 of DP 57809, then south-easterly along the prolongation in a straight line of that boundary of Lot 104 to the point at which the prolongation intersects the southern boundary of Jetty Road, then generally easterly and south-easterly along that boundary of Jetty Road to the point at which it meets the north-western boundary of Emu Street, then in a straight line by the shortest route (across Emu Street) to the south-eastern boundary of Emu Street, then north-easterly along that boundary of Emu Street to the point of commencement.	on 1 January 2011.	possession of liquor is prohibited.
Wallaroo—Area 4 (see Schedule 2: Wallaroo—Plan 3) The area in and adjacent to Wallaroo bounded as follows: commencing at the point at which the northern boundary of Jetty Road meets the south-western boundary of Lot 104 of DP 57809, then north-westerly along that boundary of Lot 104 and the prolongation in a straight line of that boundary to the low water mark on the eastern side of Spencer Gulf (Wallaroo Bay), then generally easterly and north-easterly along the low water mark to the southern side of the southern breakwater of the Copper Cove Marina, then along the low water mark on the southern, western and northern sides of that southern breakwater and the southern side of the marina to the point at which it is intersected by the prolongation in a straight line of the south-eastern boundary of Lot 1000 of DP 56470 (from the easternmost point on that south-eastern boundary), then south-westerly along that prolongation and boundary of Lot 1000 to the point at which it meets the north-western boundary of Heritage Drive, then generally south-westerly along that boundary of Heritage Drive to the point at which it meets the western boundary of Lot 50 of FP 29064, then generally northerly along that boundary of Lot 50 to the southern boundary of the road reserve that constitutes the Office Beach Caravan Park access road, then generally south-westerly and southerly along that boundary of the road reserve to the point at which it meets the eastern boundary of Lot 13 of DP 44166, then generally north-westerly and northerly along the boundary of Lot 13 to the point at which the northern boundary of Lot 13 meets the southern boundary of Lot 322 of TP 211103, then generally westerly along that boundary of Lot 322 to the point at which it meets the eastern boundary of Lot 104 of DP 57809, then south-easterly along that boundary of Lot 104 to the northern boundary of Jetty Road, then westerly along that boundary of Jetty Road to the point of commencement.	12 noon on 31 December 2010 to 7 am on 1 January 2011.	The consumption of liquor is prohibited and the possession of liquor is prohibited.

Schedule 2—Plans of short term dry areas

Adelaide—Plan 1

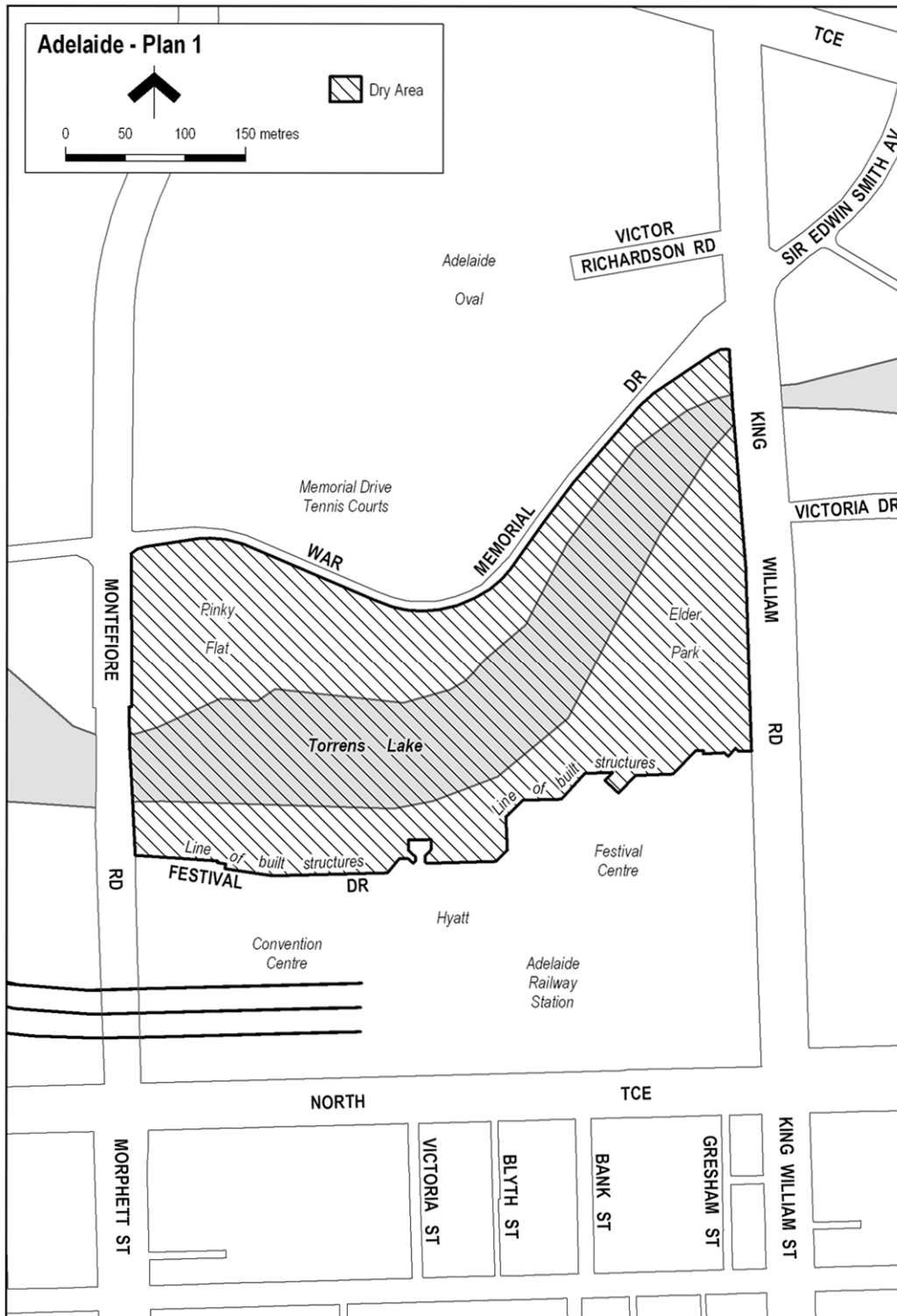

Alexandrina Council—Plan 2

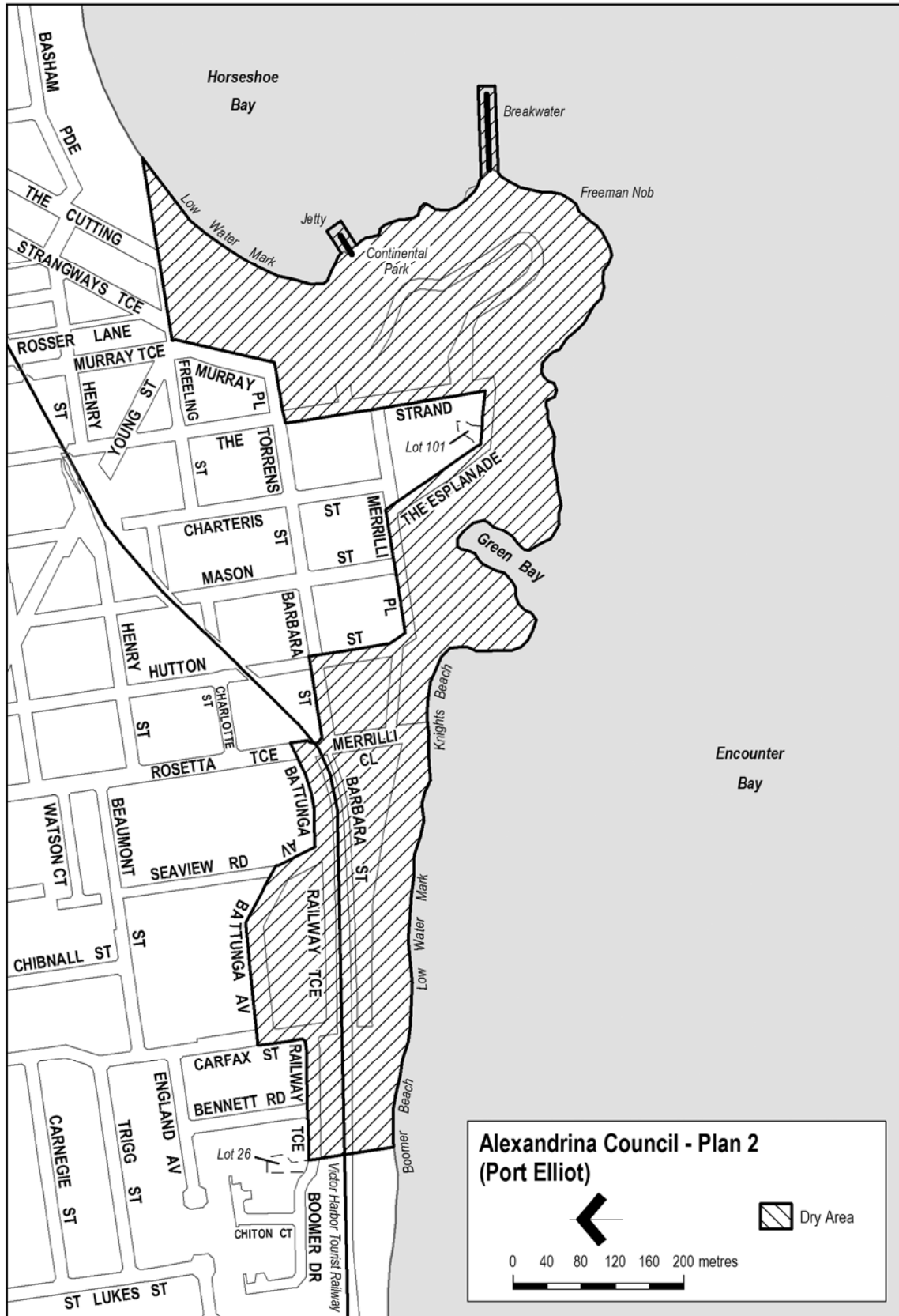

Alexandrina Council—Plan 3 (Middleton)

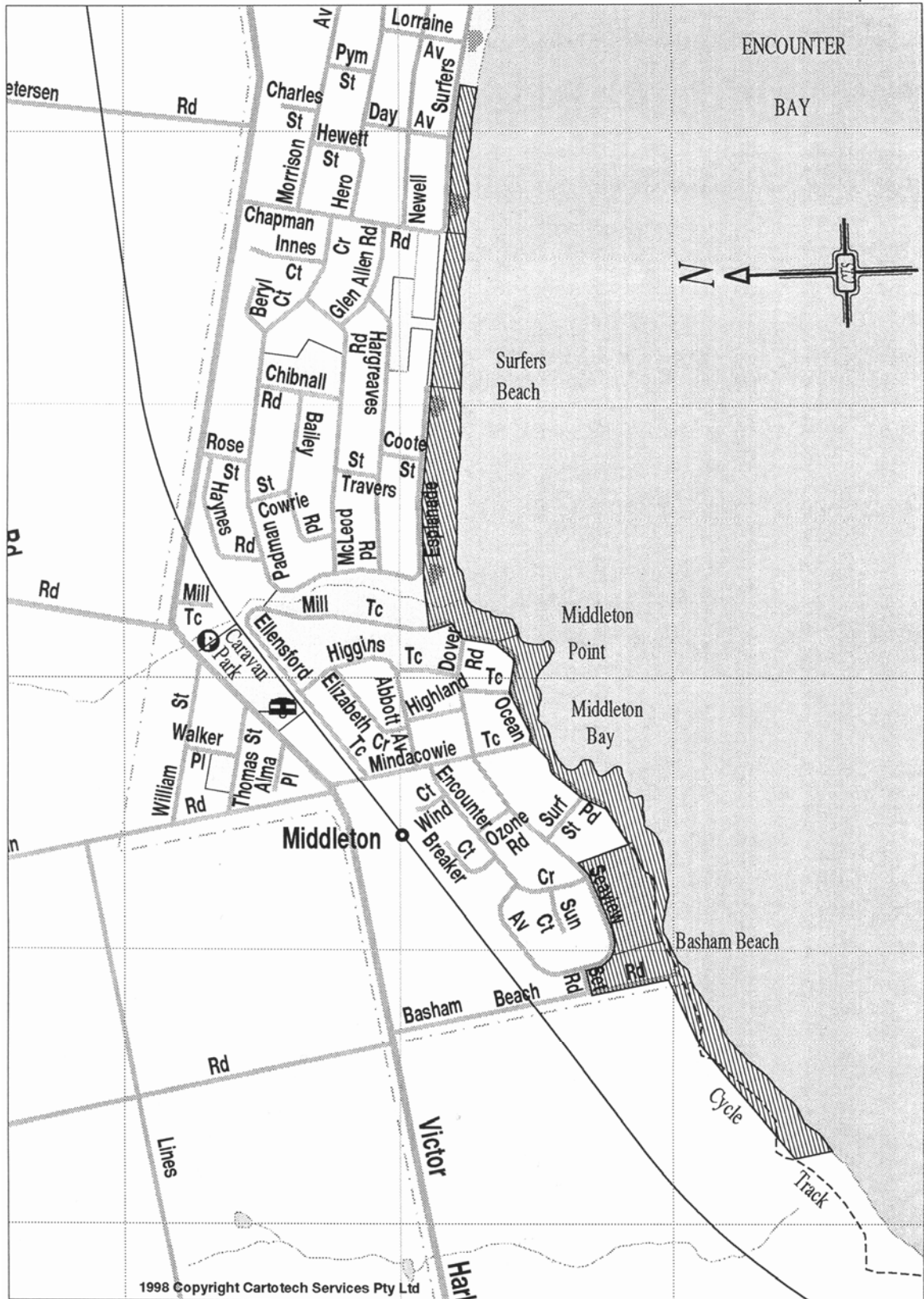

Alexandrina Council—Plan 4 (Goolwa Beach Carpark)

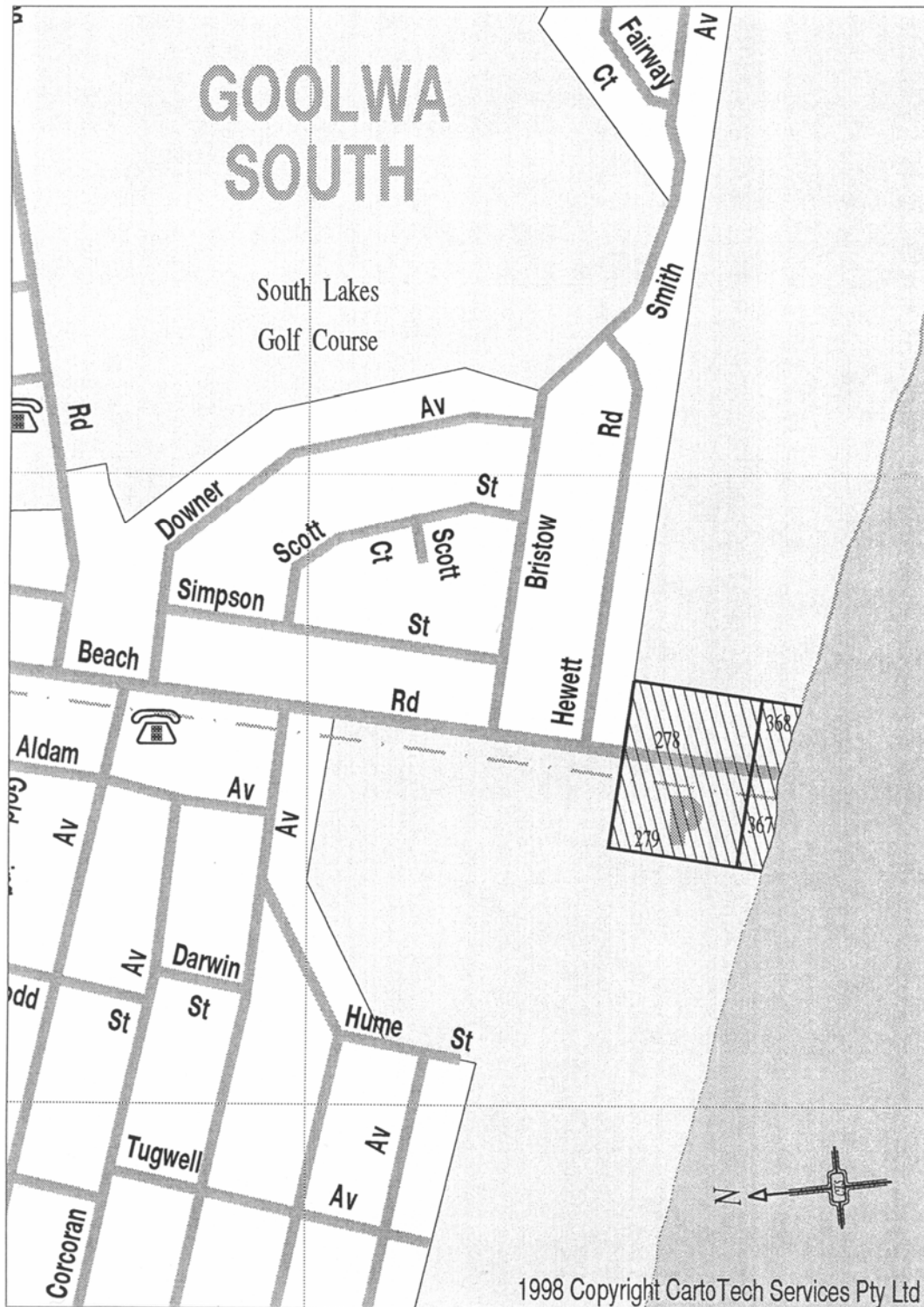

Alexandrina Council—Plan 6

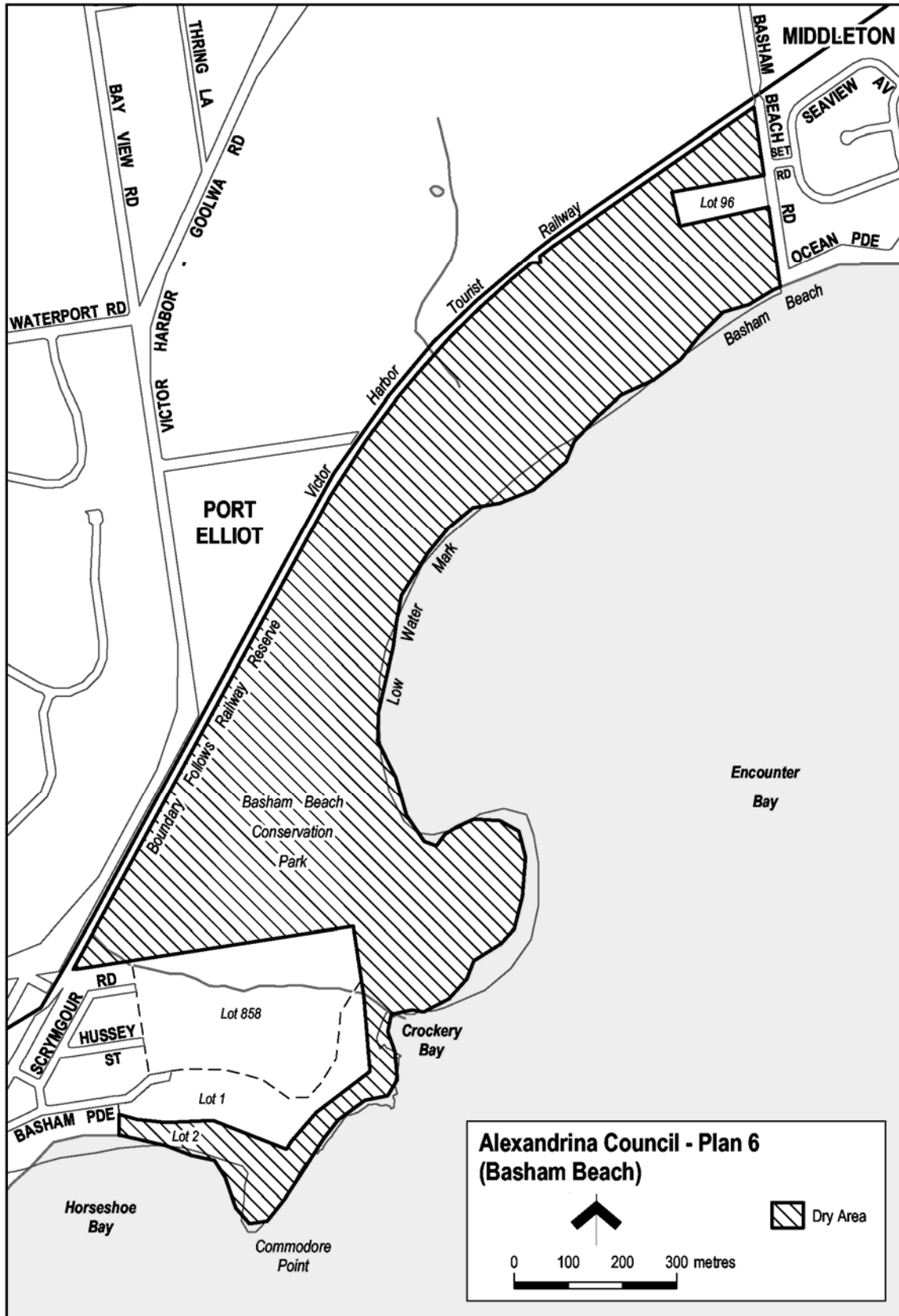

Beachport—Plan 1

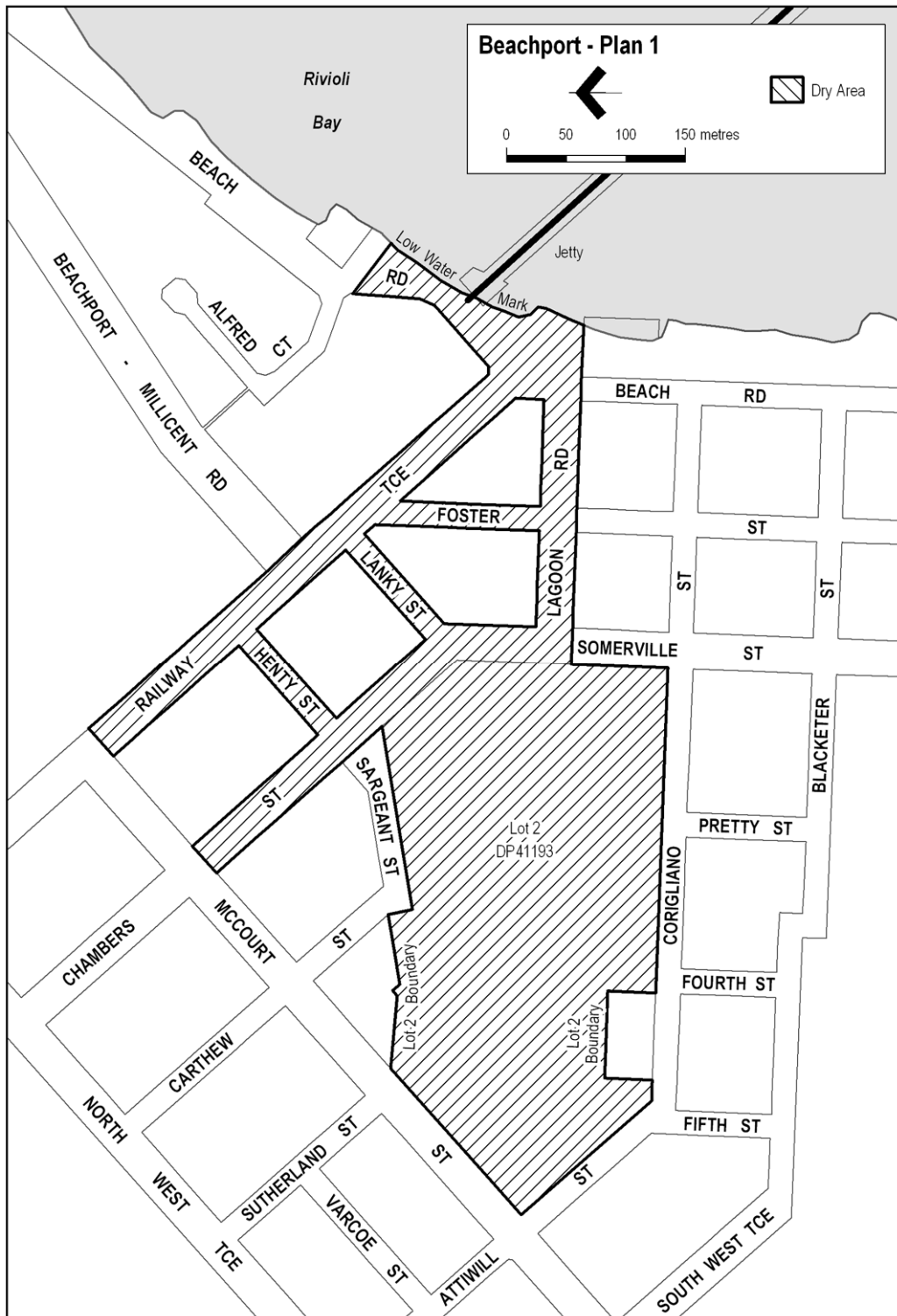

Coffin Bay—Plan 1

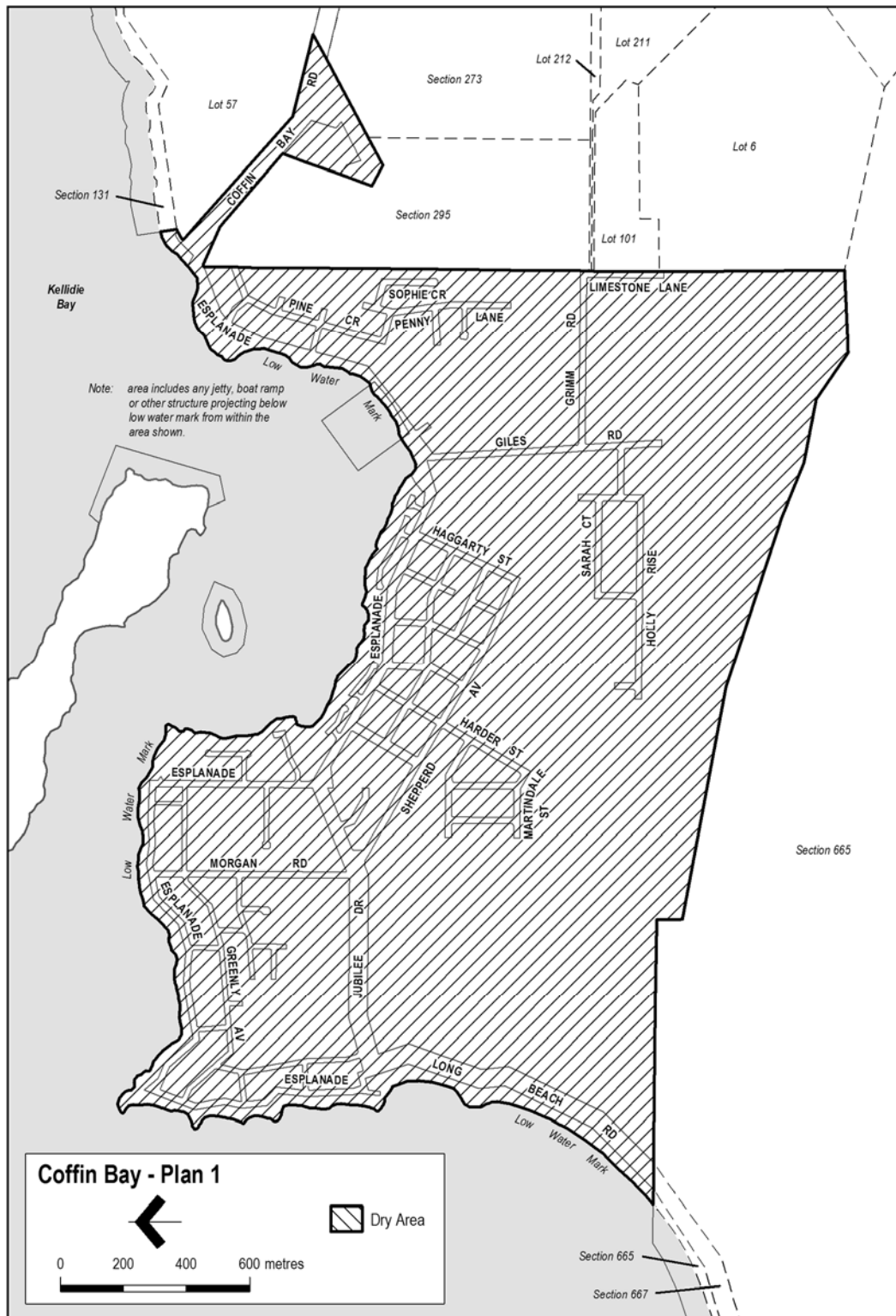

Murray Bridge—Plan 1

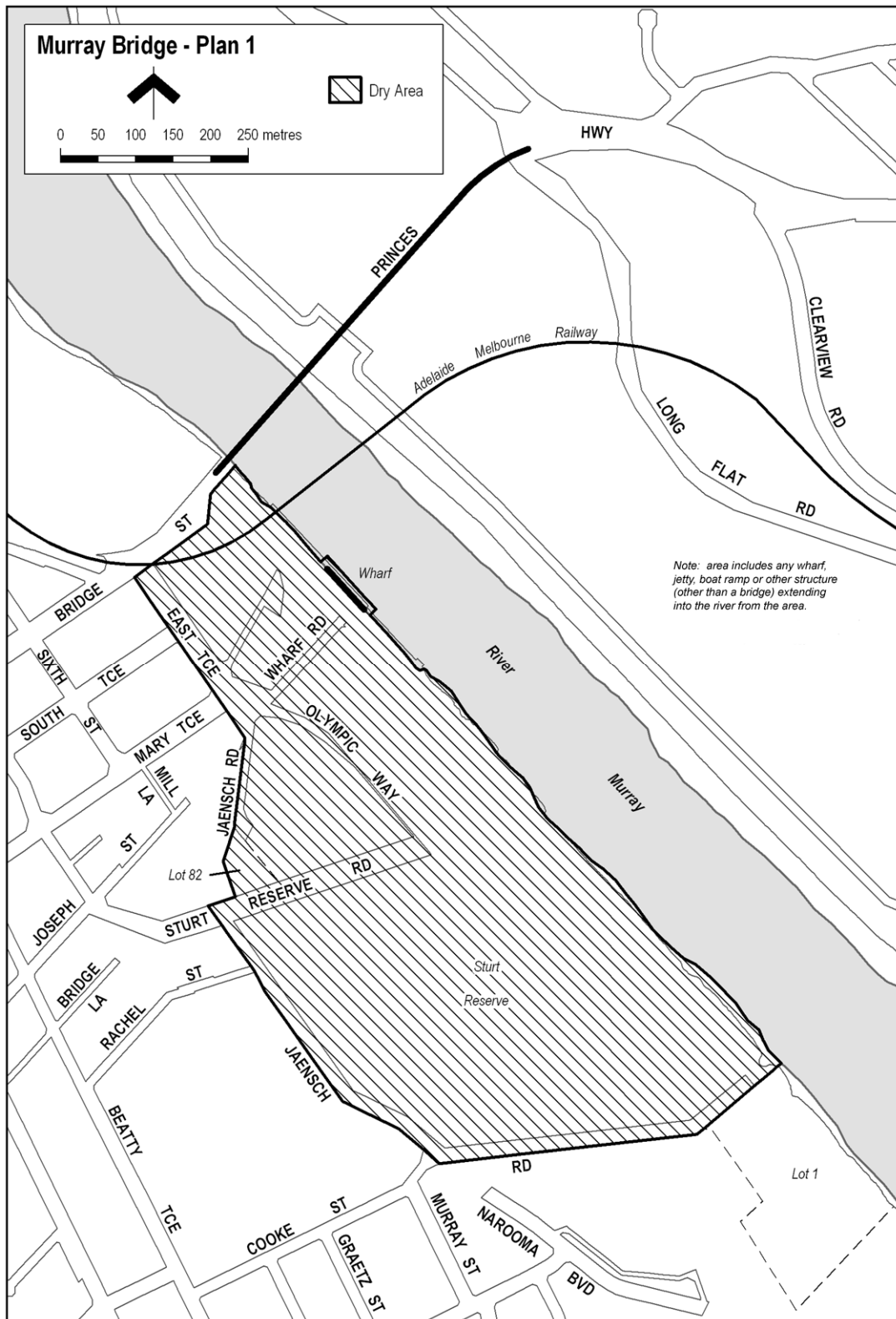

Port Augusta—Plan 1

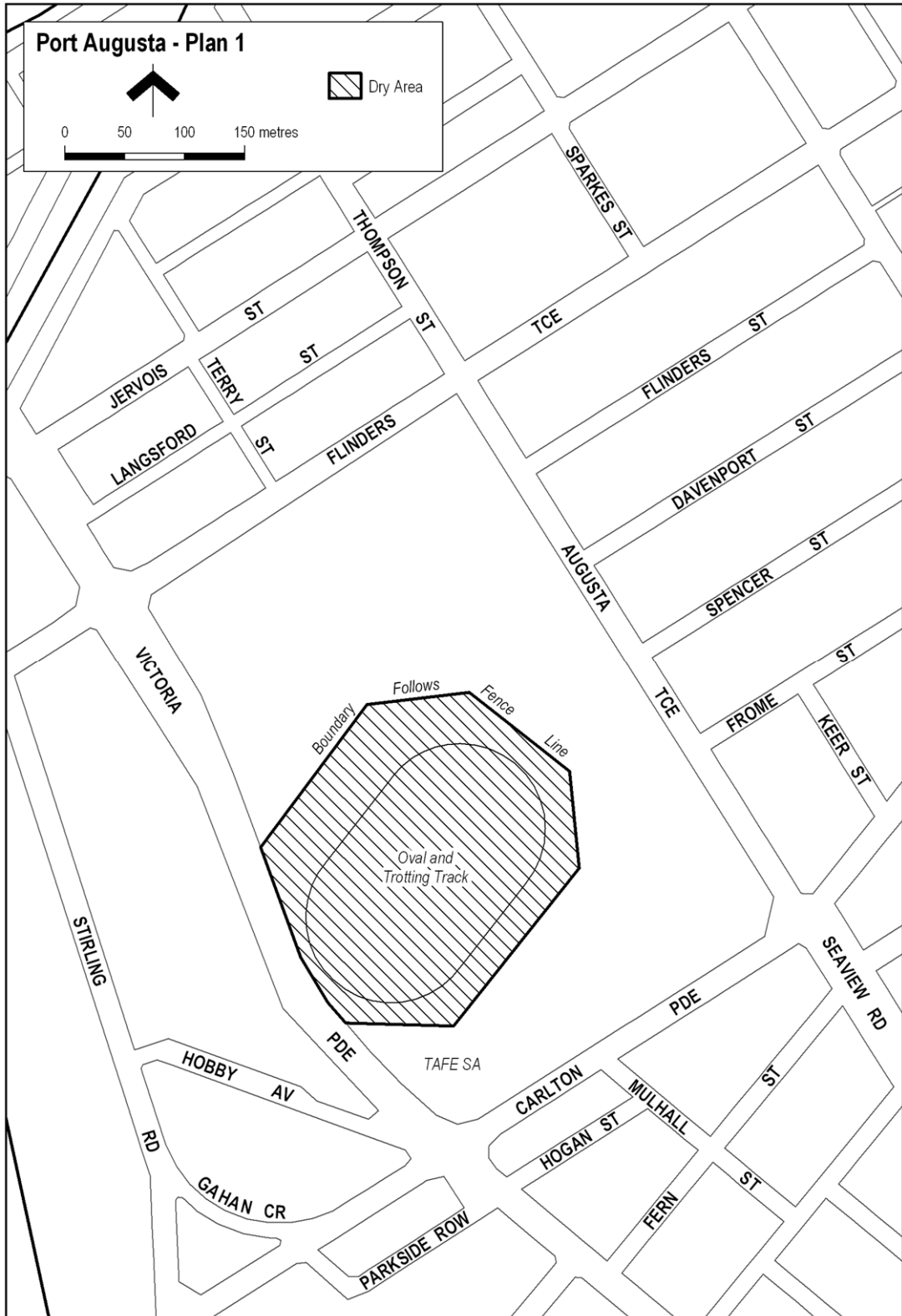

Port Vincent—Plan 1

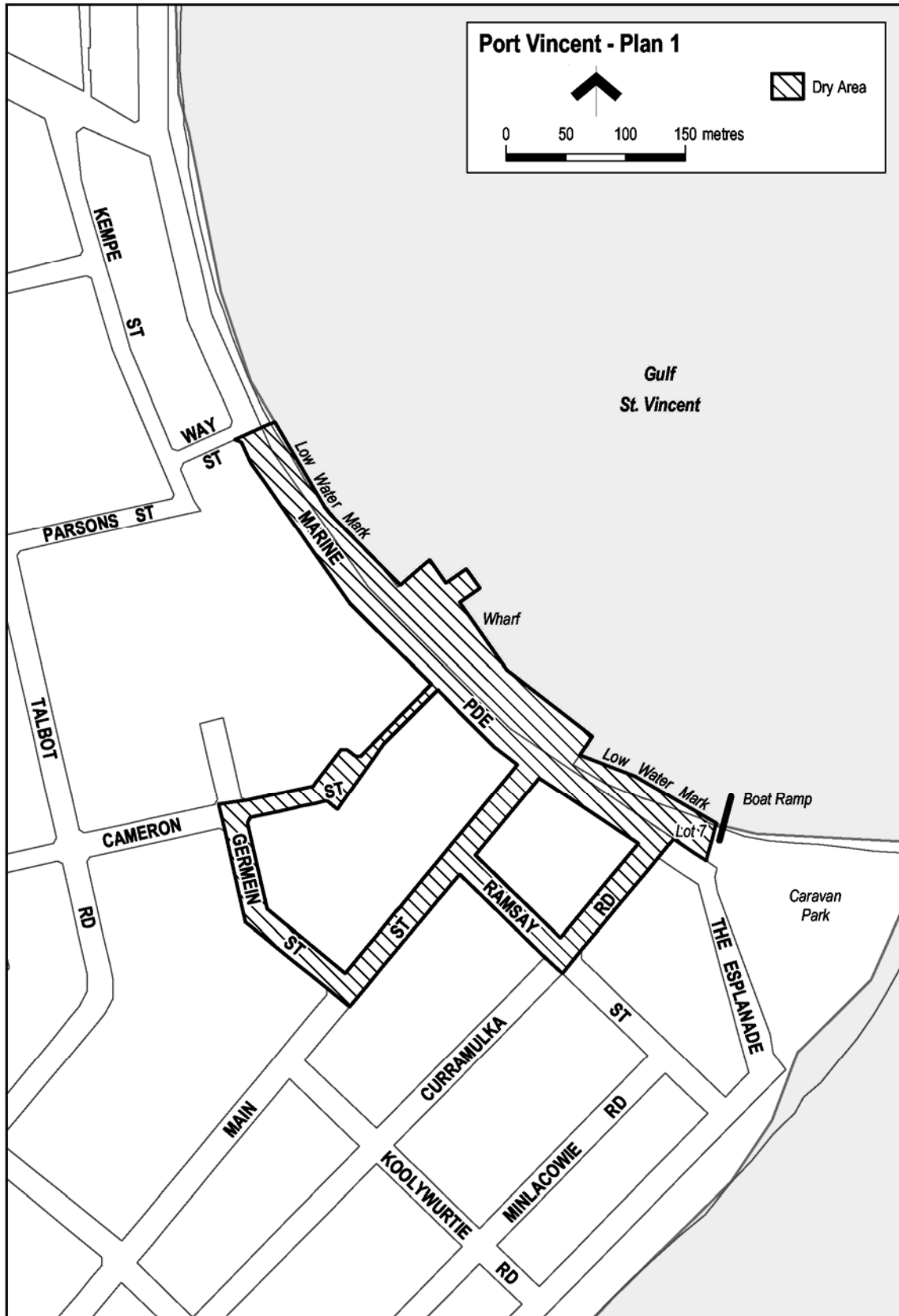

Robe—Plan 1

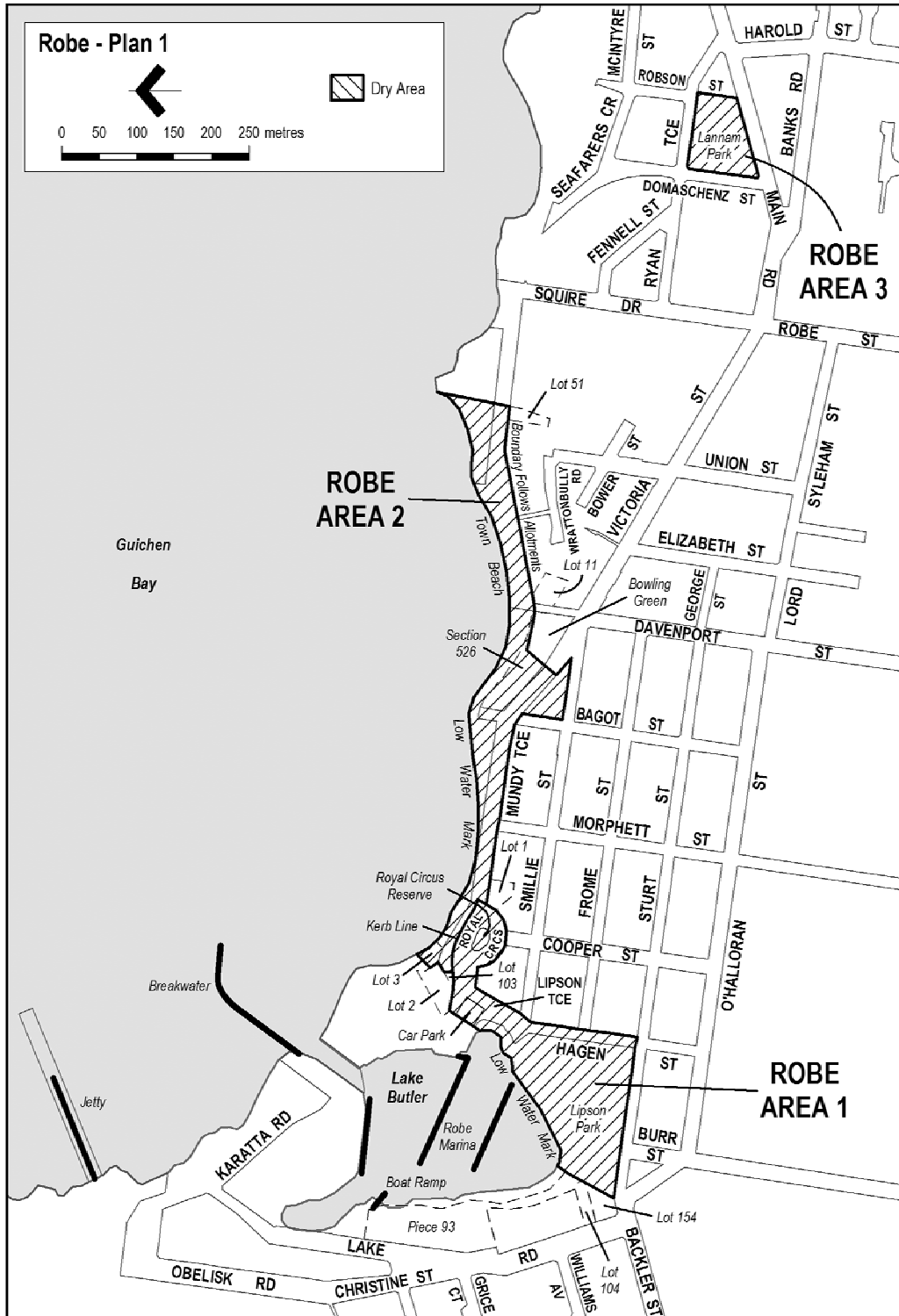

Robe—Plan 2

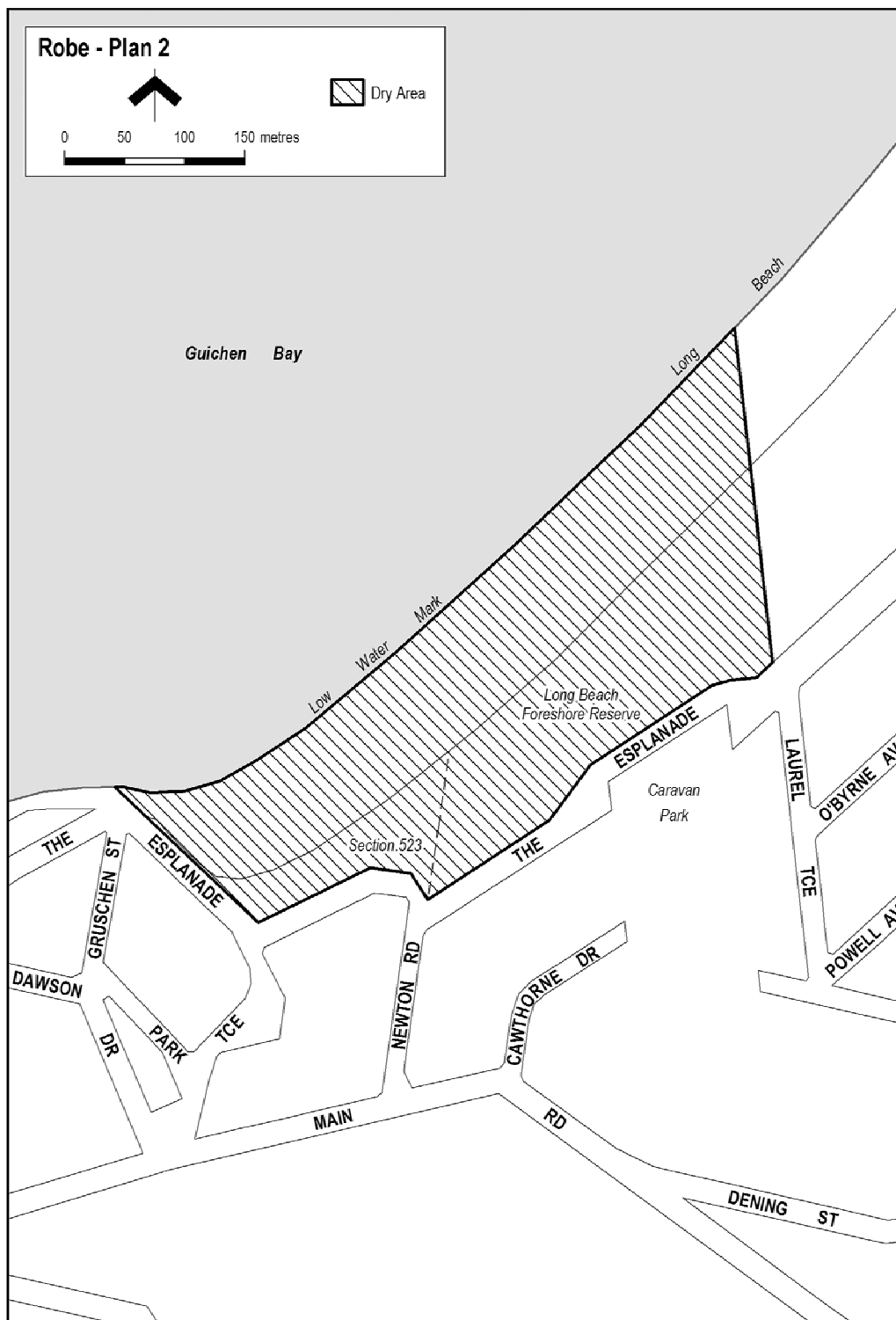

Tumby Bay—Plan 1

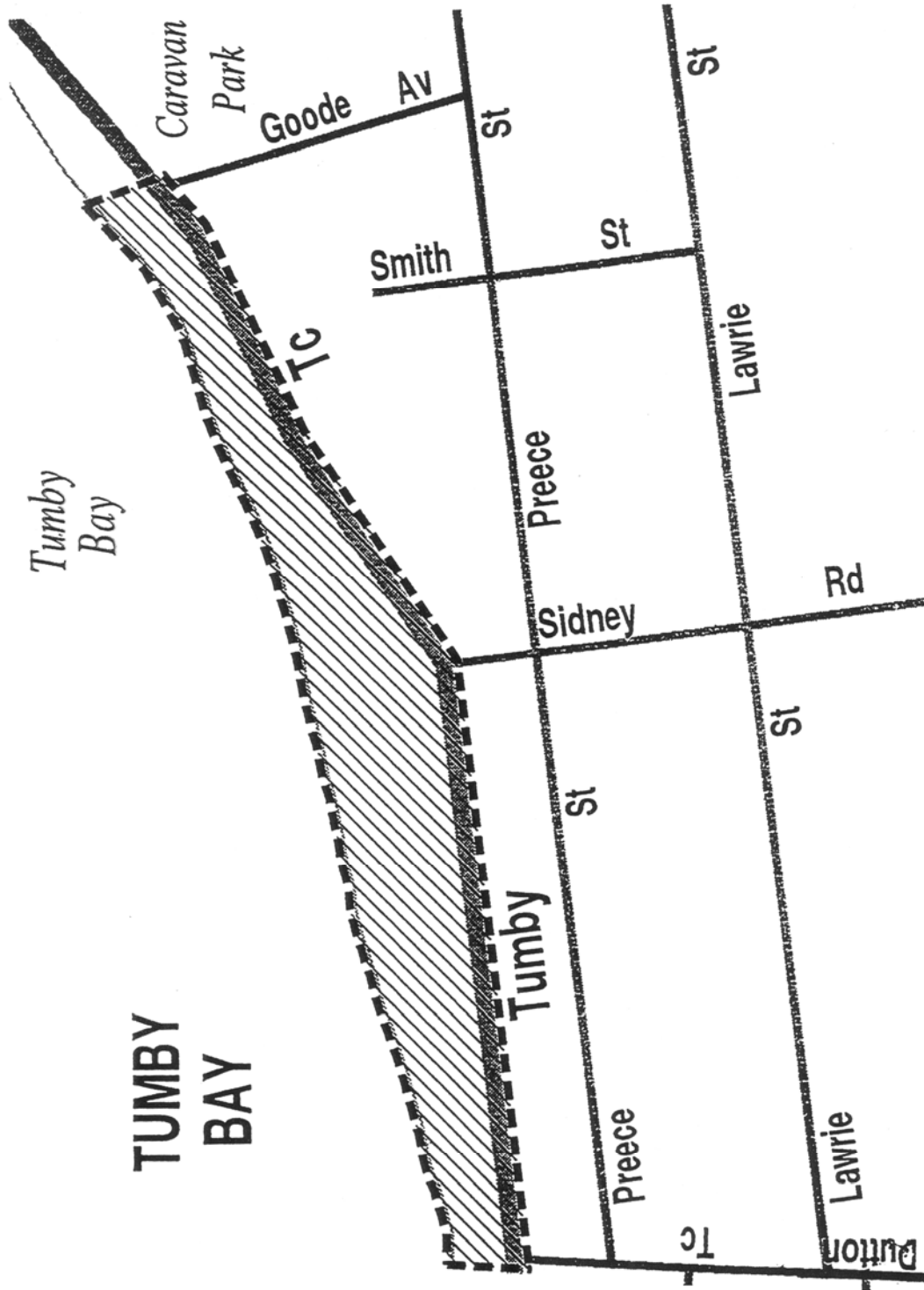

Victor Harbor—Plan 1

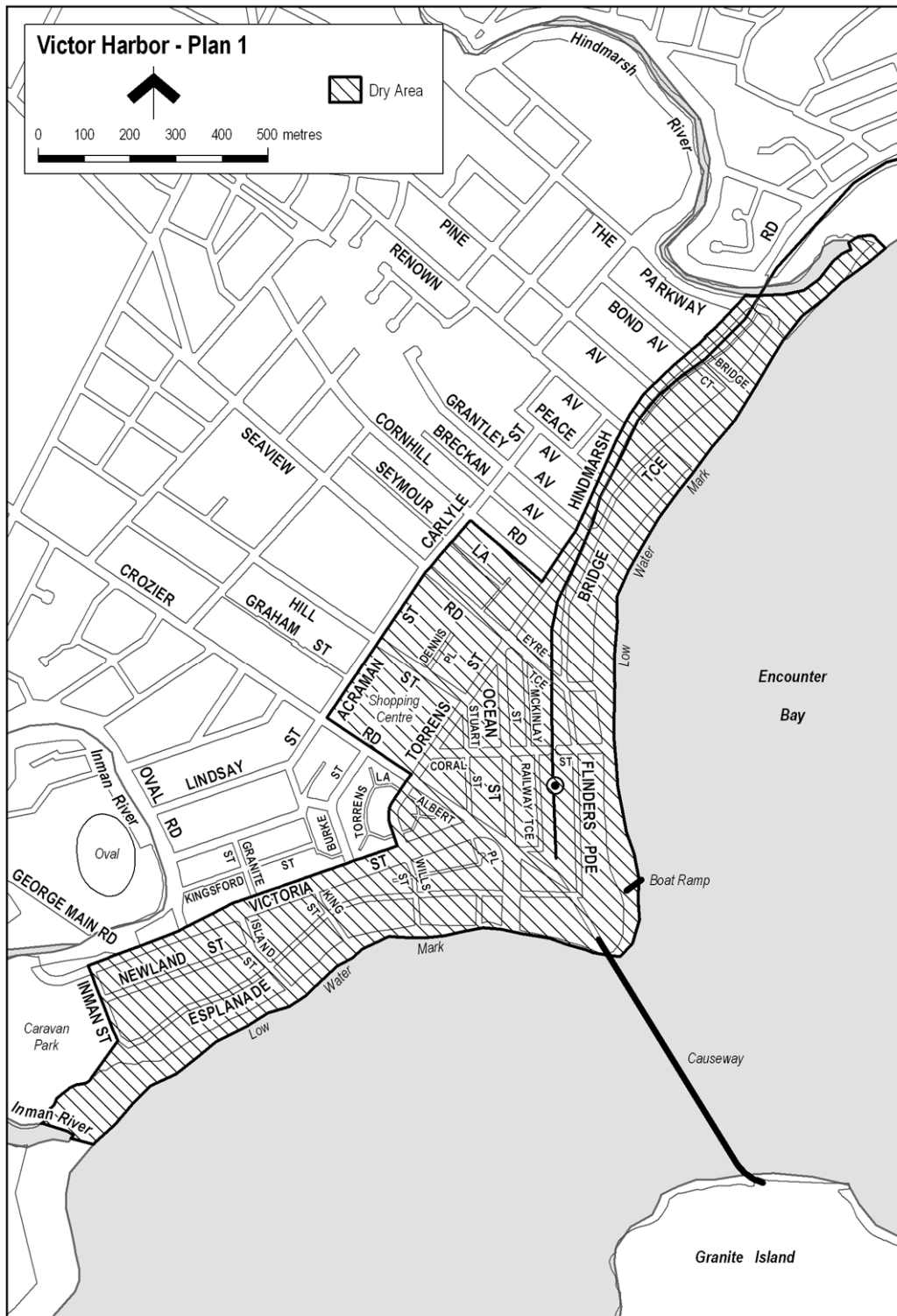

Wallaroo—Plan 1

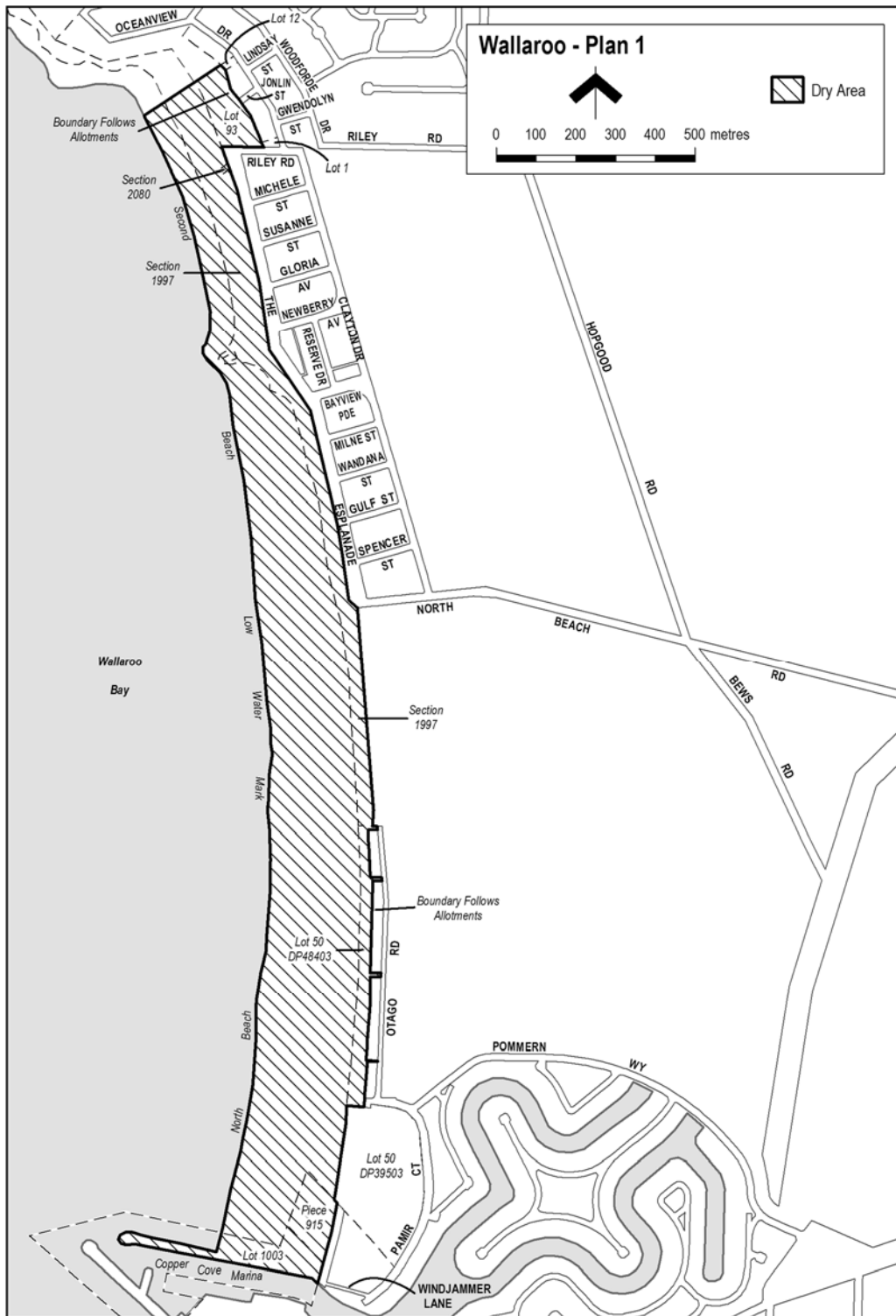

Wallaroo—Plan 2

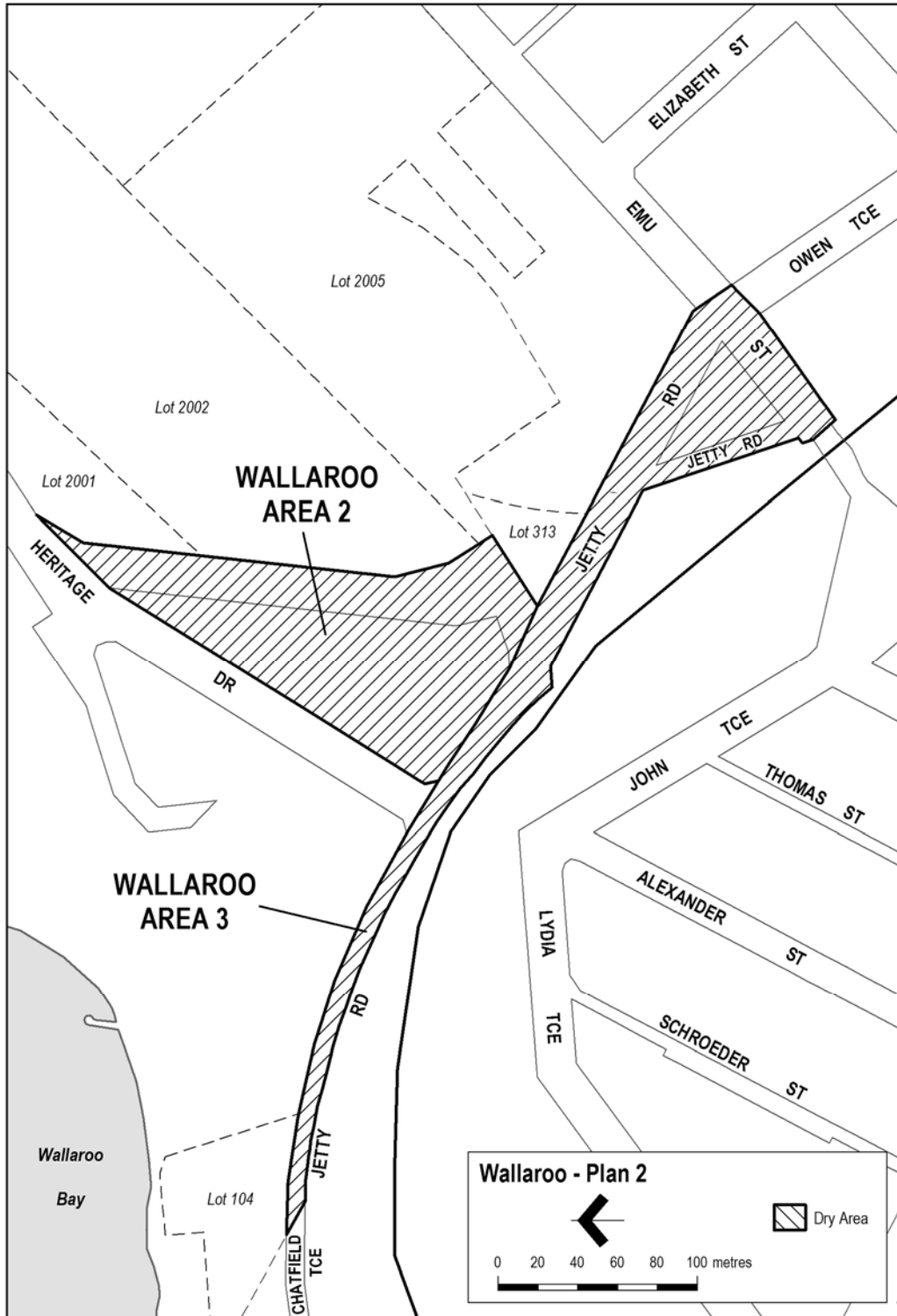

Wallaroo—Plan 3

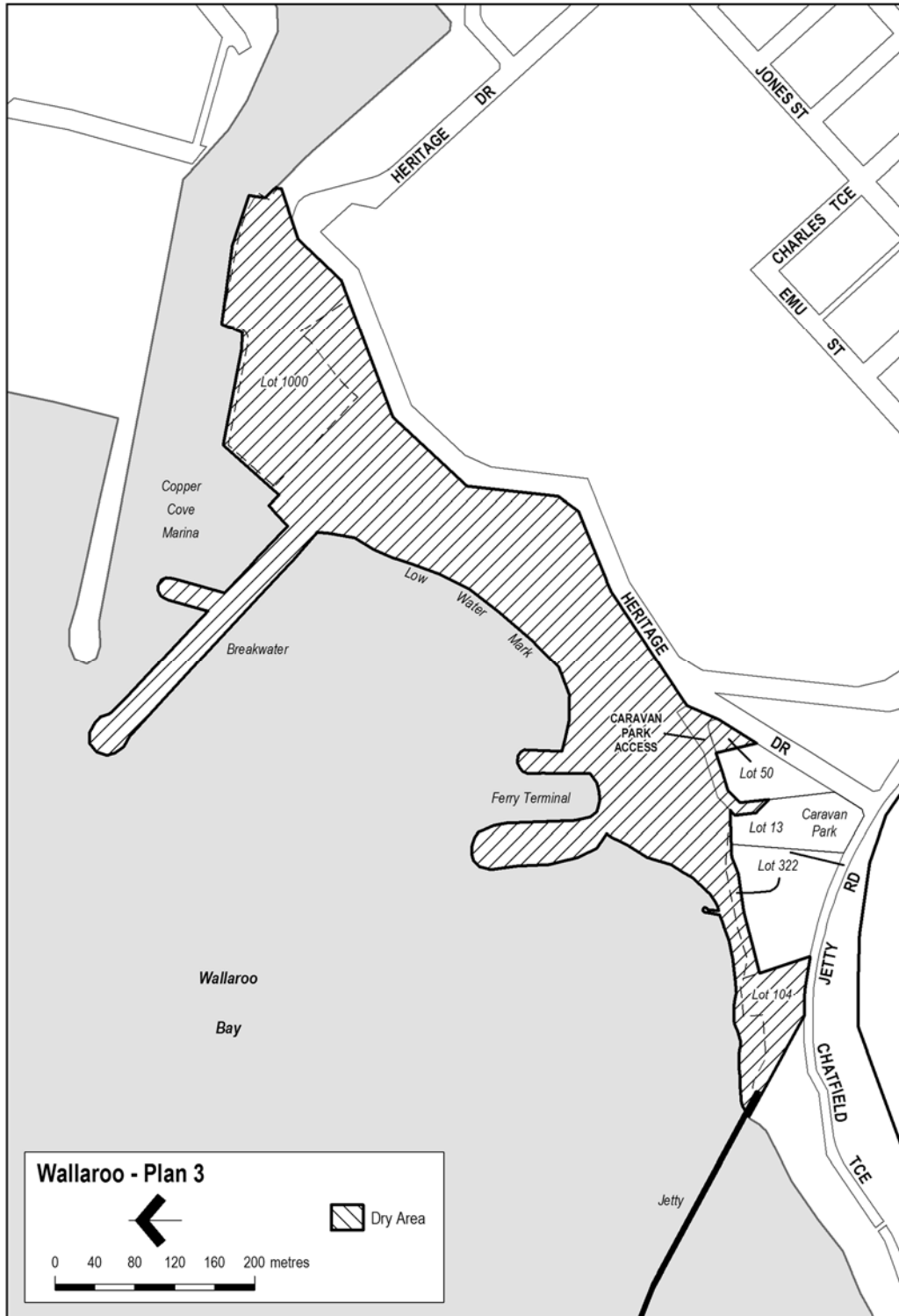

Legislative history

Notes

- Please note—References in the legislation to other legislation or instruments or to titles of bodies or offices are not automatically updated as part of the program for the revision and publication of legislation and therefore may be obsolete.
- Earlier versions of these regulations (historical versions) are listed at the end of the legislative history.
- For further information relating to the Act and subordinate legislation made under the Act see the Index of South Australian Statutes or www.legislation.sa.gov.au.

Principal regulations and variations

New entries appear in bold.

Year	No	Reference	Commencement
1997	212	<i>Gazette 2.10.1997 p965</i>	2.10.1997: r 2
1997	252	<i>Gazette 24.12.1997 p1817</i>	24.12.1997: r 2
1998	215	<i>Gazette 17.12.1998 p1978</i>	17.12.1998: r 2
1999	196	<i>Gazette 30.9.1999 p1386</i>	30.9.1999: r 2
1999	260	<i>Gazette 16.12.1999 p3474</i>	16.12.1999: r 2
2000	244	<i>Gazette 12.10.2000 p2489</i>	12.10.2000: r 2
2000	292	<i>Gazette 21.12.2000 p3775</i>	21.12.2000: r 2
2001	267	<i>Gazette 20.12.2001 p5660</i>	20.12.2001: r 2
2002	175	<i>Gazette 29.8.2002 p3279</i>	29.8.2002: r 2
2002	215	<i>Gazette 14.11.2002 p4209</i>	14.11.2002: r 2
2002	235	<i>Gazette 19.12.2002 p4823</i>	19.12.2002: r 2
2002	236	<i>Gazette 19.12.2002 p4824</i>	19.12.2002: r 2
2003	224	<i>Gazette 6.11.2003 p4012</i>	6.11.2003: r 2
2003	228	<i>Gazette 20.11.2003 p4206</i>	20.11.2003: r 2
2003	252	<i>Gazette 18.12.2003 p4571</i>	18.12.2003: r 2
2003	258	<i>Gazette 18.12.2003 p4594</i>	18.12.2003: r 2
2003	265	<i>Gazette 18.12.2003 p4631</i>	18.12.2003: r 2
2003	270	<i>Gazette 18.12.2003 p4661</i>	18.12.2003: r 2
2004	236	<i>Gazette 11.11.2004 p4307</i>	11.11.2004: r 2
2004	255	<i>Gazette 16.12.2004 p4617</i>	16.12.2004: r 2
2005	190	<i>Gazette 1.9.2005 p3215</i>	1.9.2005: r 2
2005	241	<i>Gazette 17.11.2005 p3984</i>	17.11.2005: r 2
2005	272	<i>Gazette 15.12.2005 p4334</i>	15.12.2005: r 2
2006	236	<i>Gazette 19.10.2006 p3755</i>	19.10.2006: r 2
2006	247	<i>Gazette 9.11.2006 p3960</i>	9.11.2006: r 2
2006	252	<i>Gazette 16.11.2006 p4010</i>	16.11.2006: r 2
2006	260	<i>Gazette 7.12.2006 p4277</i>	7.12.2006: r 2

2006	261	<i>Gazette 7.12.2006 p4279</i>	7.12.2006: r 2
2006	262	<i>Gazette 7.12.2006 p4281</i>	7.12.2006: r 2
2006	265	<i>Gazette 7.12.2006 p4289</i>	7.12.2006: r 2
2006	266	<i>Gazette 7.12.2006 p4291</i>	7.12.2006: r 2
2006	277	<i>Gazette 14.12.2006 p4411</i>	14.12.2006: r 2
2007	232	<i>Gazette 20.9.2007 p3750</i>	20.9.2007: r 2
2007	251	<i>Gazette 1.11.2007 p4146</i>	1.11.2007: r 2
2007	257	<i>Gazette 15.11.2007 p4246</i>	15.11.2007: r 2
2007	258	<i>Gazette 15.11.2007 p4249</i>	15.11.2007: r 2
2007	272	<i>Gazette 29.11.2007 p4411</i>	29.11.2007: r 2
2007	296	<i>Gazette 6.12.2007 p4755</i>	6.12.2007: r 2
2007	300	<i>Gazette 13.12.2007 p4824</i>	13.12.2007: r 2
2007	301	<i>Gazette 13.12.2007 p4827</i>	13.12.2007: r 2
2007	303	<i>Gazette 13.12.2007 p4835</i>	13.12.2007: r 2
2007	304	<i>Gazette 13.12.2007 p4837</i>	13.12.2007: r 2
2007	308	<i>Gazette 13.12.2007 p4852</i>	13.12.2007: r 2
2008	280	<i>Gazette 30.10.2008 p5011</i>	30.10.2008: r 2
2008	281	<i>Gazette 30.10.2008 p5013</i>	30.10.2008: r 2
2008	283	<i>Gazette 6.11.2008 p5062</i>	6.11.2008: r 2
2008	289	<i>Gazette 4.12.2008 p5363</i>	4.12.2008: r 2
2008	290	<i>Gazette 4.12.2008 p5365</i>	4.12.2008: r 2
2008	291	<i>Gazette 4.12.2008 p5367</i>	4.12.2008: r 2
2008	292	<i>Gazette 4.12.2008 p5369</i>	4.12.2008: r 2
2008	294	<i>Gazette 4.12.2008 p5373</i>	4.12.2008: r 2
2008	295	<i>Gazette 4.12.2008 p5375</i>	4.12.2008: r 2
2008	312	<i>Gazette 18.12.2008 p5681</i>	18.12.2008: r 2
2008	313	<i>Gazette 18.12.2008 p5683</i>	18.12.2008: r 2
2009	239	<i>Gazette 24.9.2009 p4721</i>	24.9.2009: r 2
2009	240	<i>Gazette 24.9.2009 p4723</i>	24.9.2009: r 2
2009	255	<i>Gazette 29.10.2009 p5028</i>	29.10.2009: r 2
2009	256	<i>Gazette 29.10.2009 p5030</i>	29.10.2009: r 2
2009	267	<i>Gazette 19.11.2009 p5217</i>	19.11.2009: r 2
2009	268	<i>Gazette 19.11.2009 p5219</i>	19.11.2009: r 2
2009	270	<i>Gazette 19.11.2009 p5223</i>	19.11.2009: r 2
2009	277	<i>Gazette 3.12.2009 p5991</i>	3.12.2009: r 2
2009	279	<i>Gazette 10.12.2009 p6185</i>	10.12.2009: r 2
2009	280	<i>Gazette 10.12.2009 p6187</i>	10.12.2009: r 2
2009	281	<i>Gazette 10.12.2009 p6189</i>	10.12.2009: r 2
2009	282	<i>Gazette 10.12.2009 p6191</i>	10.12.2009: r 2
2009	286	<i>Gazette 10.12.2009 p6202</i>	10.12.2009: r 2
2009	292	<i>Gazette 10.12.2009 p6227</i>	10.12.2009: r 2
2009	293	<i>Gazette 10.12.2009 p6229</i>	10.12.2009: r 2
2009	294	<i>Gazette 10.12.2009 p6231</i>	10.12.2009: r 2

2010	3	<i>Gazette 14.1.2010 p68</i>	14.1.2010: r 2
2010	16	<i>Gazette 11.2.2010 p743</i>	11.2.2010: r 2
2010	209	<i>Gazette 7.10.2010 p5050</i>	7.10.2010: r 2
2010	210	<i>Gazette 7.10.2010 p5054</i>	7.10.2010: r 2
2010	211	<i>Gazette 14.10.2010 p5089</i>	14.10.2010: r 2
2010	215	<i>Gazette 4.11.2010 p5231</i>	4.11.2010: r 2
2010	216	<i>Gazette 4.11.2010 p5233</i>	4.11.2010: r 2
2010	217	<i>Gazette 4.11.2010 p5238</i>	4.11.2010: r 2
2010	235	<i>Gazette 2.12.2010 p5458</i>	2.12.2010: r 2
2010	237	<i>Gazette 2.12.2010 p5461</i>	2.12.2010: r 2
2010	238	<i>Gazette 2.12.2010 p5463</i>	2.12.2010: r 2
2010	239	<i>Gazette 2.12.2010 p5464</i>	2.12.2010: r 2
2010	240	<i>Gazette 2.12.2010 p5466</i>	2.12.2010: r 2
2010	241	<i>Gazette 2.12.2010 p5468</i>	2.12.2010: r 2
2010	242	<i>Gazette 2.12.2010 p5470</i>	2.12.2010: r 2
2010	248	<i>Gazette 2.12.2010 p5494</i>	2.12.2010: r 2
2010	255	<i>Gazette 9.12.2010 p5591</i>	9.12.2010: r 2
2010	256	<i>Gazette 9.12.2010 p5600</i>	9.12.2010: r 2

Provisions varied

New entries appear in bold.

Entries that relate to provisions that have been deleted appear in italics.

Provision	How varied	Commencement
<i>r 2</i>	<i>omitted under the Legislation Revision and Publication Act 2002</i>	<i>11.11.2004</i>
r 5	inserted by 252/1997 r 3	24.12.1997
Sch 1		
<i>Adelaide—Area 1</i>	<i>deleted by 255/2004 r 4(1)</i>	<i>16.12.2004</i>
<i>Adelaide—Area 2</i>	<i>inserted by 252/1997 r 4</i>	<i>24.12.1997</i>
	<i>varied by 215/1998 r 3(a)</i>	<i>17.12.1998</i>
	<i>substituted by 260/1999 r 3(a)</i>	<i>16.12.1999</i>
	<i>deleted by 255/2004 r 4(1)</i>	<i>16.12.2004</i>
Adelaide—Area 1	inserted by 277/2006 r 4	14.12.2006
	substituted by 303/2007 r 4	13.12.2007
	varied by 289/2008 r 4	4.12.2008
	varied by 282/2009 r 4	10.12.2009
	substituted by 237/2010 r 4	2.12.2010
Adelaide—Area 2	inserted by 308/2007 r 4	13.12.2007
	varied by 292/2008 r 4	4.12.2008
	varied by 280/2009 r 4	10.12.2009
	varied by 238/2010 r 4	2.12.2010
Adelaide—Area 3	inserted by 279/2009 r 4	10.12.2009

	varied by 239/2010 r 4	2.12.2010
Adelaide—Area 4	inserted by 16/2010 r 4	11.2.2010
	varied by 240/2010 r 4	2.12.2010
Alexandrina Council—Area 1	inserted by 252/1997 r 4	24.12.1997
	varied by 215/1998 r 3(b)	17.12.1998
	varied by 260/1999 r 3(b)	16.12.1999
	varied by 292/2000 r 3(a)	21.12.2000
	varied by 267/2001 r 3(a)	20.12.2001
	varied by 236/2002 r 3(a)	19.12.2002
	varied by 258/2003 r 4(1)	18.12.2003
	varied by 255/2004 r 4(2)	16.12.2004
	varied by 272/2005 r 4(1)	15.12.2005
	varied by 261/2006 r 4(1)	7.12.2006
	substituted by 300/2007 r 4(1)	13.12.2007
	varied by 291/2008 r 4(1)	4.12.2008
	varied by 267/2009 r 4(1)	19.11.2009
	varied by 216/2010 r 4(1)	4.11.2010
Alexandrina Council—Area 2	inserted by 252/1997 r 4	24.12.1997
	varied by 215/1998 r 3(c)	17.12.1998
	varied by 260/1999 r 3(c)	16.12.1999
	varied by 292/2000 r 3(b)	21.12.2000
	varied by 267/2001 r 3(b)	20.12.2001
	varied by 236/2002 r 3(b)	19.12.2002
	varied by 258/2003 r 4(2)	18.12.2003
	varied by 255/2004 r 4(3)	16.12.2004
	varied by 272/2005 r 4(2)	15.12.2005
	varied by 261/2006 r 4(2)	7.12.2006
	varied by 300/2007 r 4(2)	13.12.2007
	varied by 291/2008 r 4(2)	4.12.2008
	varied by 267/2009 r 4(2)	19.11.2009
	substituted by 216/2010 r 4(2)	4.11.2010
Alexandrina Council—Area 3	inserted by 252/1997 r 4	24.12.1997
	varied by 215/1998 r 3(d)	17.12.1998
	varied by 260/1999 r 3(d)	16.12.1999
	varied by 292/2000 r 3(c)	21.12.2000
	varied by 267/2001 r 3(c)	20.12.2001
	varied by 236/2002 r 3(c)	19.12.2002
	varied by 258/2003 r 4(3)	18.12.2003
	varied by 255/2004 r 4(4)	16.12.2004
	varied by 272/2005 r 4(3)	15.12.2005
	varied by 261/2006 r 4(3)	7.12.2006

Liquor Licensing (Dry Areas—Short Term) Regulations 1997—9.12.2010 to 15.12.2010Legislative history

	varied by 300/2007 r 4(3)	13.12.2007
	varied by 291/2008 r 4(3)	4.12.2008
	varied by 267/2009 r 4(3)	19.11.2009
	varied by 216/2010 r 4(3)	4.11.2010
Alexandrina Council—Area 4	inserted by 252/1997 r 4	24.12.1997
	varied by 215/1998 r 3(e)	17.12.1998
	varied by 260/1999 r 3(e)	16.12.1999
	varied by 292/2000 r 3(d)	21.12.2000
	varied by 267/2001 r 3(d)	20.12.2001
	varied by 236/2002 r 3(d)	19.12.2002
	varied by 258/2003 r 4(4)	18.12.2003
	varied by 255/2004 r 4(5)	16.12.2004
	varied by 272/2005 r 4(4)	15.12.2005
	varied by 261/2006 r 4(4)	7.12.2006
	varied by 300/2007 r 4(4)	13.12.2007
	varied by 291/2008 r 4(4)	4.12.2008
	varied by 267/2009 r 4(4)	19.11.2009
	varied by 216/2010 r 4(4)	4.11.2010
Alexandrina Council—Area 5	inserted by 252/1997 r 4	24.12.1997
	varied by 215/1998 r 3(f)	17.12.1998
	varied by 260/1999 r 3(f)	16.12.1999
	varied by 292/2000 r 3(e)	21.12.2000
	varied by 267/2001 r 3(e)	20.12.2001
	varied by 236/2002 r 3(e)	19.12.2002
	varied by 258/2003 r 4(5)	18.12.2003
	varied by 255/2004 r 4(6)	16.12.2004
	varied by 272/2005 r 4(5)	15.12.2005
	varied by 261/2006 r 4(5)	7.12.2006
	varied by 300/2007 r 4(5)	13.12.2007
	varied by 291/2008 r 4(5)	4.12.2008
	varied by 267/2009 r 4(5)	19.11.2009
	varied by 216/2010 r 4(5)	4.11.2010
Alexandrina Council—Area 6	inserted by 255/2004 r 4(7)	16.12.2004
	varied by 272/2005 r 4(6)	15.12.2005
	varied by 261/2006 r 4(6)	7.12.2006
	varied by 300/2007 r 4(6)	13.12.2007
	varied by 291/2008 r 4(6)	4.12.2008
	varied by 267/2009 r 4(6)	19.11.2009
	varied by 216/2010 r 4(6)	4.11.2010
Beachport—Area 1	inserted by 252/1997 r 4	24.12.1997
	substituted by 215/1998 r 3(g)	17.12.1998

	varied by 260/1999 r 3(g)	16.12.1999
	varied by 292/2000 r 3(f)	21.12.2000
	varied by 267/2001 r 3(f)	20.12.2001
	varied by 236/2002 r 3(f)	19.12.2002
	varied by 265/2003 r 4	18.12.2003
	varied by 255/2004 r 4(8)	16.12.2004
	varied by 272/2005 r 4(7)	15.12.2005
	varied by 265/2006 r 4	7.12.2006
	substituted by 257/2007 r 4	15.11.2007
	varied by 281/2008 r 4	30.10.2008
	varied by 294/2009 r 4	10.12.2009
	varied by 235/2010 r 4	2.12.2010
Coffin Bay—Area 1	inserted by 256/2009 r 4	29.10.2009
	varied by 209/2010 r 4(1), (2)	7.10.2010
Glenelg—Area 1	inserted by 215/1998 r 3(g)	17.12.1998
	substituted by 260/1999 r 3(h)	16.12.1999
	varied by 292/2000 r 3(g)	21.12.2000
	varied by 267/2001 r 3(g)	20.12.2001
	varied by 236/2002 r 3(g)	19.12.2002
	varied by 258/2003 r 4(6)	18.12.2003
	varied by 255/2004 r 4(9)	16.12.2004
	varied by 272/2005 r 4(8), (9)	15.12.2005
	varied by 266/2006 r 4(1), (2)	7.12.2006
	varied by 258/2007 r 4	15.11.2007
	varied by 294/2008 r 4	4.12.2008
	varied by 286/2009 r 4	10.12.2009
	varied by 242/2010 r 4	2.12.2010
Morgan—Area 1	inserted by 301/2007 r 4	13.12.2007
	varied by 312/2008 r 4	18.12.2008
	varied by 281/2009 r 4	10.12.2009
	varied by 248/2010 r 4	2.12.2010
Murray Bridge— Area 1	inserted by 252/2006 r 4	16.11.2006
Millicent—Area 1	<i>inserted by 260/1999 r 3(h)</i>	<i>16.12.1999</i>
	<i>deleted by 255/2004 r 4(10)</i>	<i>16.12.2004</i>
Normanville—Area 1	<i>inserted by 252/1997 r 4</i>	<i>24.12.1997</i>
	<i>varied by 215/1998 r 3(h)</i>	<i>17.12.1998</i>
	<i>substituted by 260/1999 r 3(h)</i>	<i>16.12.1999</i>
	<i>deleted by 255/2004 r 4(10)</i>	<i>16.12.2004</i>
Peterborough— Area 1	<i>inserted by 267/2001 r 3(h)</i>	<i>20.12.2001</i>
	<i>varied by 236/2002 r 3(h)</i>	<i>19.12.2002</i>
	<i>varied by 252/2003 r 4(1), (2)</i>	<i>18.12.2003</i>

Liquor Licensing (Dry Areas—Short Term) Regulations 1997—9.12.2010 to 15.12.2010
 Legislative history

	<i>deleted by 255/2004 r 4(10)</i>	16.12.2004
Peterborough— Area 2	<i>inserted by 267/2001 r 3(h)</i>	20.12.2001
	<i>varied by 236/2002 r 3(i)</i>	19.12.2002
	<i>varied by 252/2003 r 4(3)</i>	18.12.2003
	<i>deleted by 255/2004 r 4(10)</i>	16.12.2004
Port Augusta— Area 1	<i>inserted by 196/1999 r 3</i>	30.9.1999
	<i>deleted by 267/2001 r 3(h)</i>	20.12.2001
	<i>inserted by 175/2002 r 3</i>	29.8.2002
	<i>deleted by 255/2004 r 4(10)</i>	16.12.2004
Port Augusta— Area 1	<i>inserted by 190/2005 r 4</i>	1.9.2005
Port Augusta— Area 2	<i>inserted by 196/1999 r 3</i>	30.9.1999
	<i>deleted by 267/2001 r 3(h)</i>	20.12.2001
	<i>inserted by 175/2002 r 3</i>	29.8.2002
	<i>deleted by 255/2004 r 4(10)</i>	16.12.2004
Port Vincent— Area 1	<i>inserted by 255/2004 r 4(10)</i>	16.12.2004
	<i>varied by 272/2005 r 4(10)</i>	15.12.2005
	<i>varied by 260/2006 r 4</i>	7.12.2006
	<i>varied by 272/2007 r 4</i>	29.11.2007
Robe—Area 1	<i>inserted by 260/1999 r 3(i)</i>	16.12.1999
	<i>substituted by 292/2000 r 3(h)</i>	21.12.2000
	<i>substituted by 267/2001 r 3(h)</i>	20.12.2001
	<i>varied by 236/2002 r 3(j)</i>	19.12.2002
	<i>varied by 270/2003 r 4(1)</i>	18.12.2003
	<i>varied by 255/2004 r 4(11)</i>	16.12.2004
	<i>varied by 272/2005 r 4(11)</i>	15.12.2005
	<i>varied by 262/2006 r 4(1)</i>	7.12.2006
	<i>varied by 296/2007 r 4(1)</i>	6.12.2007
	<i>varied by 290/2008 r 4(1)</i>	4.12.2008
	<i>varied by 293/2009 r 4(1)</i>	10.12.2009
	substituted by 256/2010 r 4	9.12.2010
Robe—Area 2	<i>inserted by 260/1999 r 3(i)</i>	16.12.1999
	<i>varied by 292/2000 r 3(i)</i>	21.12.2000
	<i>substituted by 267/2001 r 3(h)</i>	20.12.2001
	<i>varied by 236/2002 r 3(k)</i>	19.12.2002
	<i>varied by 270/2003 r 4(2)</i>	18.12.2003
	<i>varied by 255/2004 r 4(12)</i>	16.12.2004
	<i>varied by 272/2005 r 4(12)</i>	15.12.2005
	<i>varied by 262/2006 r 4(2)</i>	7.12.2006
	<i>varied by 296/2007 r 4(2)</i>	6.12.2007

	varied by 290/2008 r 4(2)	4.12.2008
	varied by 293/2009 r 4(2)	10.12.2009
	substituted by 256/2010 r 4	9.12.2010
Robe—Area 3	inserted by 260/1999 r 3(i)	16.12.1999
	varied by 292/2000 r 3(j)	21.12.2000
	substituted by 267/2001 r 3(h)	20.12.2001
	varied by 236/2002 r 3(1)	19.12.2002
	varied by 270/2003 r 4(3)	18.12.2003
	varied by 255/2004 r 4(13)	16.12.2004
	varied by 272/2005 r 4(13)	15.12.2005
	varied by 262/2006 r 4(3)	7.12.2006
	varied by 296/2007 r 4(3)	6.12.2007
	varied by 290/2008 r 4(3)	4.12.2008
	varied by 293/2009 r 4(3)	10.12.2009
	substituted by 256/2010 r 4	9.12.2010
Robe—Area 4	inserted by 267/2001 r 3(h)	20.12.2001
	varied by 236/2002 r 3(m)	19.12.2002
	varied by 270/2003 r 4(4)	18.12.2003
	varied by 255/2004 r 4(14)	16.12.2004
	varied by 272/2005 r 4(14)	15.12.2005
	varied by 262/2006 r 4(4)	7.12.2006
	varied by 296/2007 r 4(4)	6.12.2007
	varied by 290/2008 r 4(4)	4.12.2008
	varied by 293/2009 r 4(4)	10.12.2009
	substituted by 256/2010 r 4	9.12.2010
Robe—Area 5	<i>inserted by 267/2001 r 3(h)</i>	<i>20.12.2001</i>
	<i>varied by 236/2002 r 3(n)</i>	<i>19.12.2002</i>
	<i>varied by 270/2003 r 4(5)</i>	<i>18.12.2003</i>
	<i>varied by 255/2004 r 4(15)</i>	<i>16.12.2004</i>
	<i>varied by 272/2005 r 4(15)</i>	<i>15.12.2005</i>
	<i>varied by 262/2006 r 4(5)</i>	<i>7.12.2006</i>
	<i>varied by 296/2007 r 4(5)</i>	<i>6.12.2007</i>
	<i>varied by 290/2008 r 4(5)</i>	<i>4.12.2008</i>
	<i>varied by 293/2009 r 4(5)</i>	<i>10.12.2009</i>
	<i>deleted by 256/2010 r 4</i>	<i>9.12.2010</i>
Roxby Downs— Area 1	<i>inserted by 244/2000 r 3</i>	<i>12.10.2000</i>
	<i>deleted by 255/2004 r 4(16)</i>	<i>16.12.2004</i>
Semaphore—Area 1	inserted by 313/2008 r 4	18.12.2008
	varied by 239/2009 r 4	24.9.2009
	varied by 210/2010 r 4	7.10.2010
Spalding—Area 1	inserted by 236/2006 r 4	19.10.2006
	varied by 232/2007 r 4(1), (2)	20.9.2007

Liquor Licensing (Dry Areas—Short Term) Regulations 1997—9.12.2010 to 15.12.2010
 Legislative history

	varied by 280/2008 r 4	30.10.2008
	varied by 270/2009 r 4	19.11.2009
	varied by 215/2010 r 4	4.11.2010
Stirling—Area 1	inserted by 268/2009 r 4	19.11.2009
	substituted by 217/2010 r 4	4.11.2010
Streaky Bay—Area 1	inserted by 255/2009 r 4	29.10.2009
Tumby Bay—Area 1	inserted by 215/1998 r 3(i)	17.12.1998
	varied by 260/1999 r 3(j)	16.12.1999
	varied by 267/2001 r 3(i)	20.12.2001
	varied by 235/2002 r 3	19.12.2002
	varied by 228/2003 r 4	20.11.2003
	varied by 255/2004 r 4(17)	16.12.2004
Two Wells—Area 1	inserted by 277/2009 r 4	3.12.2009
	varied by 241/2010 r 4	2.12.2010
Unley—Area 1	inserted by 3/2010 r 4	14.1.2010
<i>Victor Harbor— Area 1 before substitution by 236/2004</i>	<i>inserted by 252/1997 r 4</i>	<i>24.12.1997</i>
	<i>varied by 215/1998 r 3(j)</i>	<i>17.12.1998</i>
	<i>varied by 260/1999 r 3(k), (l)</i>	<i>16.12.1999</i>
	<i>varied by 292/2000 r 3(k)</i>	<i>21.12.2000</i>
	<i>substituted by 215/2002 r 3(a)</i>	<i>14.11.2002</i>
	<i>varied by 224/2003 r 4(1)</i>	<i>6.11.2003</i>
Victor Harbor— Area 1	substituted by 236/2004 r 4(1)	11.11.2004
	varied by 241/2005 r 4(1)	17.11.2005
	varied by 247/2006 r 4(1), (2)	9.11.2006
	varied by 251/2007 r 4(1)	1.11.2007
	varied by 283/2008 r 4(1)	6.11.2008
	varied by 240/2009 r 4(1)	24.9.2009
	varied by 211/2010 r 4(1)	14.10.2010
Victor Harbor— Area 2	inserted by 260/1999 r 3(m)	16.12.1999
	varied by 292/2000 r 3(l)	21.12.2000
	varied by 215/2002 r 3(b)	14.11.2002
	varied by 224/2003 r 4(2)	6.11.2003
	varied by 236/2004 r 4(2)	11.11.2004
	varied by 241/2005 r 4(2)	17.11.2005
	substituted by 247/2006 r 4(3)	9.11.2006
	varied by 251/2007 r 4(2)	1.11.2007
	varied by 283/2008 r 4(2), (3)	6.11.2008
	varied by 240/2009 r 4(2)	24.9.2009
	varied by 211/2010 r 4(2), (3)	14.10.2010

Victor Harbor— Area 3	inserted by 247/2006 r 4(3)	9.11.2006
	varied by 251/2007 r 4(3)	1.11.2007
	varied by 283/2008 r 4(4)	6.11.2008
	varied by 240/2009 r 4(3)	24.9.2009
	varied by 211/2010 r 4(4)	14.10.2010
Wallaroo—Area 1	inserted by 304/2007 r 4	13.12.2007
	varied by 295/2008 r 4(1)	4.12.2008
	varied by 292/2009 r 4(1)	10.12.2009
	varied by 255/2010 r 4(1), (2)	9.12.2010
Wallaroo—Area 2	inserted by 304/2007 r 4	13.12.2007
	varied by 295/2008 r 4(2)	4.12.2008
	varied by 292/2009 r 4(2)	10.12.2009
	substituted by 255/2010 r 4(3)	9.12.2010
Wallaroo—Area 3	inserted by 255/2010 r 4(3)	9.12.2010
Wallaroo—Area 4	inserted by 255/2010 r 4(3)	9.12.2010
Sch 2		
<i>Adelaide—Plan 1</i>	<i>deleted by 255/2004 r 5(1)</i>	<i>16.12.2004</i>
Adelaide—Plan 1	inserted by 308/2007 r 5 (Sch 1)	13.12.2007
<i>Adelaide—Plan 2</i>	<i>inserted by 252/1997 r 5</i>	<i>24.12.1997</i>
	<i>substituted by 260/1999 r 4(a) (Sch)</i>	<i>16.12.1999</i>
	<i>deleted by 255/2004 r 5(1)</i>	<i>16.12.2004</i>
<i>Alexandrina Council—Plan 1</i>	<i>inserted by 252/1997 r 5</i>	<i>24.12.1997</i>
	<i>deleted by 300/2007 r 5</i>	<i>13.12.2007</i>
Alexandrina Council—Plan 2	inserted by 252/1997 r 5	24.12.1997
	substituted by 216/2010 r 5 (Sch 1)	4.11.2010
Alexandrina Council—Plan 3	inserted by 252/1997 r 5	24.12.1997
Alexandrina Council—Plan 4	inserted by 252/1997 r 5	24.12.1997
Alexandrina Council—Plan 5	inserted by 252/1997 r 5	24.12.1997
Alexandrina Council—Plan 6	inserted by 255/2004 r 5(2) (Sch 1)	16.12.2004
<i>Beachport—Plan 1</i>	<i>inserted by 252/1997 r 5</i>	<i>24.12.1997</i>
	<i>deleted by 215/1998 r 4(a)</i>	<i>17.12.1998</i>
Beachport—Plan 1	inserted by 257/2007 r 5 (Sch 1)	15.11.2007
Coffin Bay—Plan 1	inserted by 209/2010 r 5 (Sch 1)	7.10.2010
Glenelg—Plan 1	inserted by 260/1999 r 4(b) (Sch)	16.12.1999
	substituted by 272/2005 r 5 (Sch 1)	15.12.2005
	substituted by 266/2006 r 5 (Sch 1)	7.12.2006
Murray Bridge— Plan 1	inserted by 252/2006 r 5 (Sch 1)	16.11.2006

Liquor Licensing (Dry Areas—Short Term) Regulations 1997—9.12.2010 to 15.12.2010
 Legislative history

<i>Normanville—Plan 1</i>	<i>inserted by 252/1997 r 5</i>	<i>24.12.1997</i>
	<i>substituted by 260/1999 r 4(b) (Sch)</i>	<i>16.12.1999</i>
	<i>deleted by 255/2004 r 5(3)</i>	<i>16.12.2004</i>
Port Augusta— Plan 1	inserted by 196/1999 r 4	30.9.1999
	deleted by 267/2001 r 4	20.12.2001
	inserted by 175/2002 r 4	29.8.2002
	deleted by 255/2004 r 5(3)	16.12.2004
	inserted by 190/2005 r 5 (Sch 1)	1.9.2005
<i>Port Augusta— Plan 2</i>	<i>inserted by 196/1999 r 4</i>	<i>30.9.1999</i>
	<i>deleted by 267/2001 r 4</i>	<i>20.12.2001</i>
	<i>inserted by 175/2002 r 4</i>	<i>29.8.2002</i>
	<i>deleted by 255/2004 r 5(3)</i>	<i>16.12.2004</i>
Port Vincent—Plan 1	inserted by 255/2004 r 5(3) (Sch 1)	16.12.2004
Robe—Plan 1	inserted by 260/1999 r 4(c) (Sch)	16.12.1999
	substituted by 292/2000 r 4	21.12.2000
	substituted by 267/2001 r 4	20.12.2001
	substituted by 256/2010 r 5 (Sch 1)	9.12.2010
Robe—Plan 2	inserted by 260/1999 r 4(c) (Sch)	16.12.1999
	substituted by 267/2001 r 4	20.12.2001
	substituted by 256/2010 r 5 (Sch 1)	9.12.2010
Spalding—Plan 1	inserted by 232/2007 r 5 (Sch 1)	20.9.2007
Tumby Bay—Plan 1	inserted by 215/1998 r 4(b)	17.12.1998
Victor Harbor— Plan 1	inserted by 252/1997 r 5	24.12.1997
	substituted by 215/2002 r 4	14.11.2002
	substituted by 236/2004 r 5 (Sch 1)	11.11.2004
	substituted by 247/2006 r 5 (Sch 1)	9.11.2006
Victor Harbor— Plan 2	inserted by 247/2006 r 5 (Sch 1)	9.11.2006
	substituted by 283/2008 r 5 (Sch 1)	6.11.2008
	substituted by 211/2010 r 5 (Sch 1)	14.10.2010
Walleroo—Plan 1	inserted by 304/2007 r 5 (Sch 1)	13.12.2007
	substituted by 255/2010 r 5 (Sch 1)	9.12.2010
Walleroo—Plan 2	inserted by 304/2007 r 5 (Sch 1)	13.12.2007
	substituted by 255/2010 r 5 (Sch 1)	9.12.2010
Walleroo—Plan 3	inserted by 255/2010 r 5 (Sch 1)	9.12.2010

Historical versions

Reprint No 1—24.12.1997
 Reprint No 2—17.12.1998
 Reprint No 3—30.9.1999
 Reprint No 4—16.12.1999

Reprint No 5—12.10.2000
Reprint No 6—21.12.2000
Reprint No 7—20.12.2001
Reprint No 8—29.8.2002
Reprint No 9—14.11.2002
Reprint No 10—19.12.2002
Reprint No 11—6.11.2003
Reprint No 12—20.11.2003
Reprint No 13—18.12.2003
11.11.2004
16.12.2004
1.9.2005
17.11.2005
15.12.2005
19.10.2006
9.11.2006 (electronic only)
16.11.2006
7.12.2006 (electronic only)
14.12.2006
20.9.2007
1.11.2007
15.11.2007
29.11.2007
6.12.2007 (electronic only)
13.12.2007
30.10.2008
6.11.2008
4.12.2008
18.12.2008
24.9.2009
29.10.2009
19.11.2009
3.12.2009 (electronic only)
10.12.2009
14.1.2010
11.2.2010
7.10.2010 (electronic only)
14.10.2010
4.11.2010
2.12.2010 (electronic only)